

# Portfolio Landscape Architect Eng/MSc N.W.H. Frencken



October 2010

# Table of contents

<b>Introduction</b>	3
<b>Bachelor Part</b>	
Cemetery at Bennekom	4
Structural Development Plan Walcheren	6
The Green Axis, Almere	8
Bachelor Thesis, Structural Vision for the Gelderse Valley	10
<b>Master Part</b>	
Internship at BRO in Vught, The Netherlands	12
<i>Town planning parcelling plan in Harreveld</i>	12
<i>Urban town planning design vision for a housing location on an intensification site in Ulestraten</i>	13
<i>Structural plan agricultural and food cluster in West Brabant</i>	14
<i>Parcelling plan WEGA dwellings in Wijchen</i>	15
Master atelier, Mirroring Opposites, Arnhem	16
Erasmus in Germany and Bridge 'n square it!, Vienna	18
Master Thesis, More than just a facelift	20
<i>Developing a landscape architectural vision for the restructuring of post-war dwelling areas in The Netherlands with a focus on cultural history, Woensel Noord in Eindhoven</i>	
<b>Hollandia Lil Bi'a Part</b>	
General	30
Dammam Parks Design	31
Dammam Metropolitan Landscape Master Plan	54
Garnatah Plaza, Dammam	56
Al Othman Twin Towers, Khobar	58
Al Othman Compound, Khobar	62
Al Sanaa Square, Riyadh	64
Al Najm Park, Hofuf	68
Al Uqair Waterfront, Al Ahsa	70
<b>Epilogue</b>	73

# Introduction

From an early age on I have been interested in the human environment and the human and natural processes which build up this environment. I deepened out this fascination in my study period at the Wageningen University, where I graduated as Bachelor and Master Landscape architect. Here I did many projects and followed courses about architecture, design skills, communication, philosophy, (social) geography, cultural and design history, ecology, (project) planning, water management, traffic management and town planning. In my opinion these fields of work are highly integrated in the field of Landscape Architecture and I specialized myself in integral, sustainable designs the urban areas. This is essential since I see the landscape as an ongoing element in which other events such as architecture and transportation means take place.

As a designer I work by hand drawings as well as by computer means on multiple scale levels in the urban and the rural contexts. I deal with the higher scale levels as a Wageningen student is specialized in, but also on the lower scale levels in my study period, but this is especially strengthened in my working time in the Kingdom of Saudi Arabia. My function was designer and Master planner as well as leading the production team and managing the projects. I positioned myself more and more towards architecture and town planning.

I design from the given context, (cultural) history and spirit of places, the *Genius loci* of places. In my designs I work through the adjacent scale levels from Master Plan till details. In my approaches I have a favour for analysis, translation into concepts and the connected designs. I did projects in The Netherlands, Germany, Austria and the Kingdom of Saudi Arabia.

Since this report is made in an A4 setup, some of the scales you will find in the book look disproportioned. This is while many drawings were often originally made on A3, A1 or A0 paper sizes. Further explanation will be given in personal presentations.

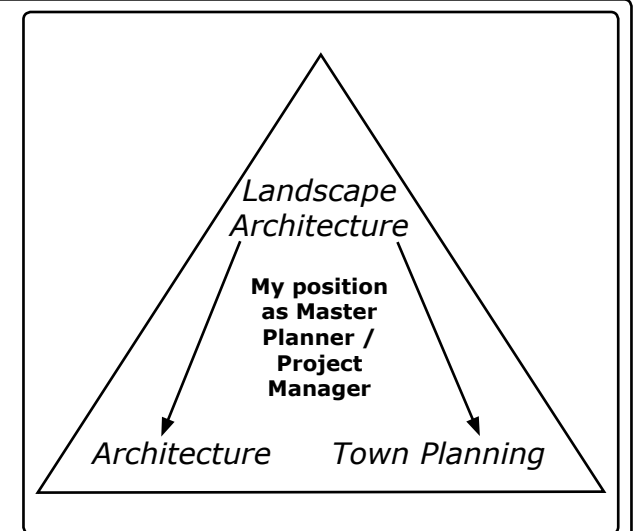
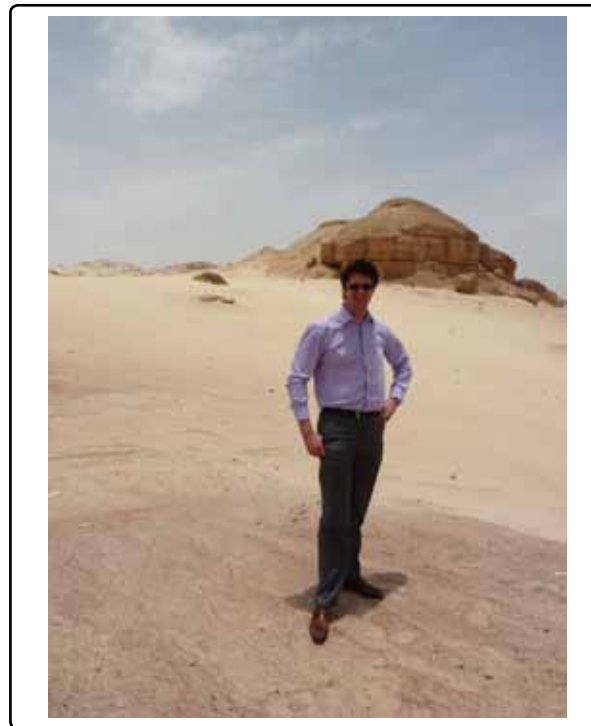



# Cemetery at Bennekom

**Location:** Brook valley between Renkum and Bennekom, The Netherlands

**Scale levels:** 1:2.000, 1:1.000, 1:500 and model 1:1.000

**Language:** Dutch

The design is located at an area where the high open fields, the dense forests and the low wet brook lands are close together. The main path structure is based on present path structures and accentuated by extra axes, which function as sight lines. Within the cemetery different religions

have different fields separated from each other.



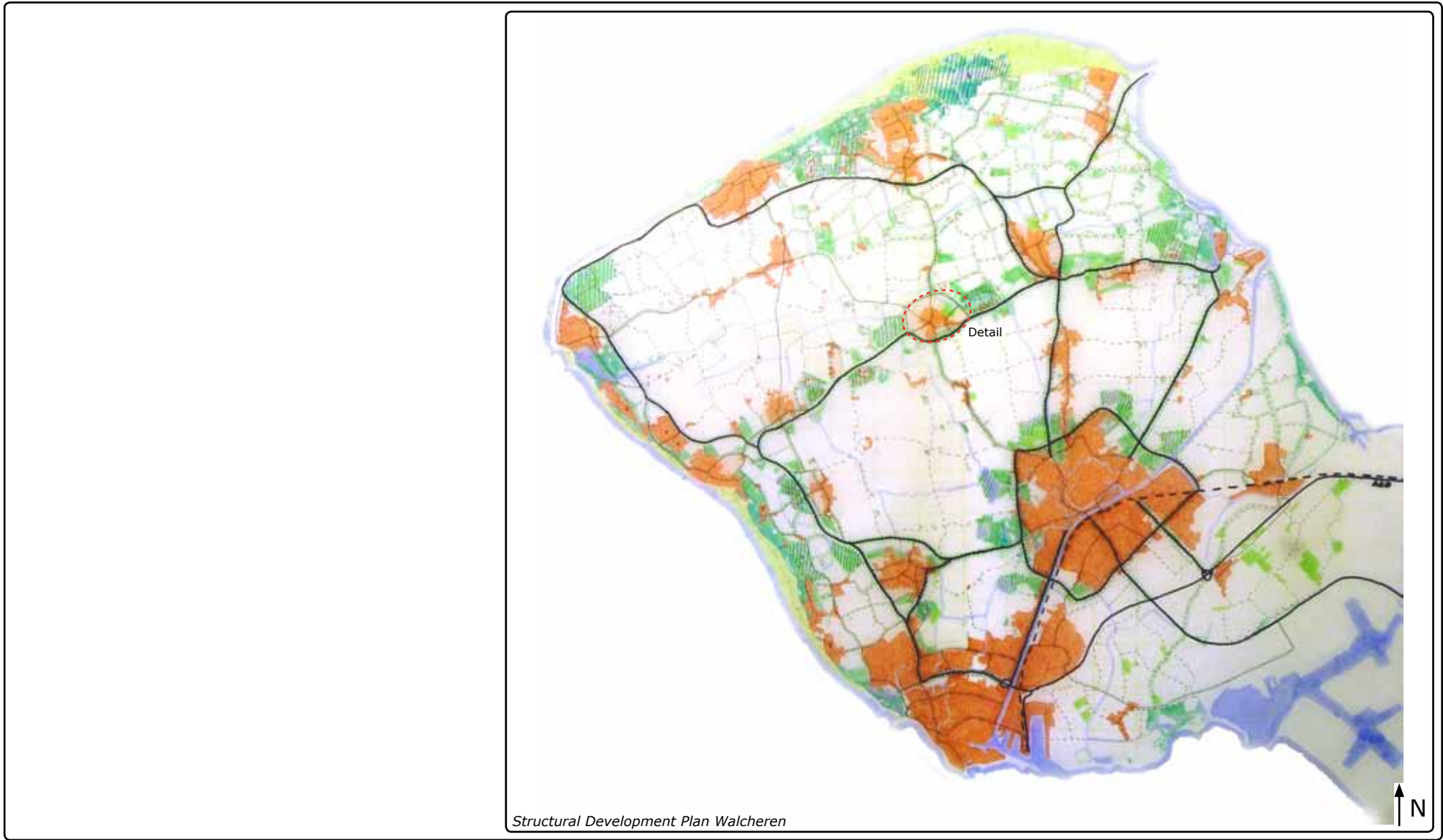

# Structural Development Plan Walcheren

**Location:** The peninsula of Walcheren, The Netherlands  
**Scale levels:** 1:25.000, 1:0.000, 1:5.000  
**Language:** Dutch

In this development plan on a high scale level multiple aspects are taken in to account such as recreation, agriculture, infrastructure, settlements and waterways. The main setup is a distinction between dense green ribbons versus large open spaces based on the original soil and layout of the peninsula's elements. New elements are located

along this setup, often shaped in estates together with nature reserves.



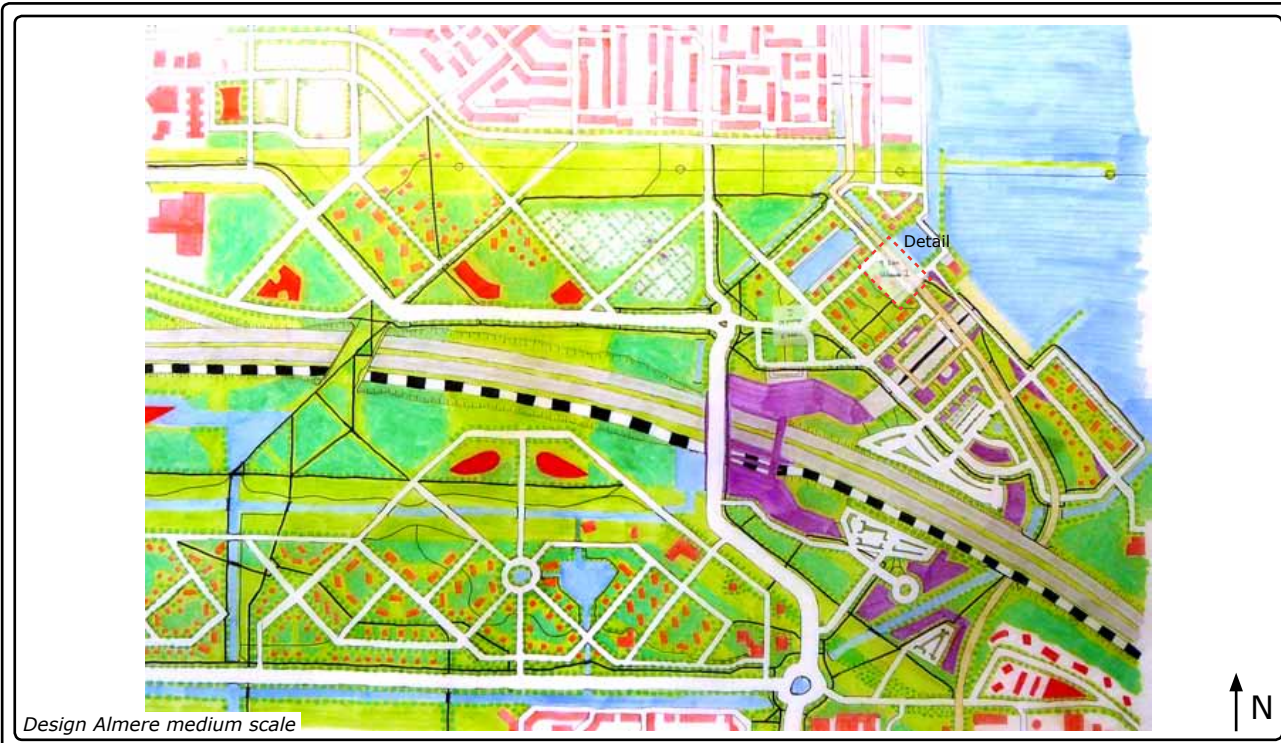

Design Almere medium scale



Detail Almere

# The Green Axis, Almere

**Location:** Almere, The Netherlands  
**Scale levels:** 1:5.000, 1:2.000, 1:500  
**Language:** Dutch

The city of Almere was originally planned according to the three-cores-approach with big green zones in between the three city parts. In one of these zones was our project area. In this area a present highway had to be expanded and a newly planned high speed rail had to be added. The main concept of my design is an experience from the highway guiding you into the city. First you

are in the open 'polder' landscape (1), then you arrive in an office area in a park setting (2), then you go through a green 'tunnel' (3) from which you 'jump' out at the Weerwater in the centre of Almere (4), where a new transfer centre will be constructed. The developed area is extra supported by sustainable waterways and the density of the park elements will be intensified towards the city centre. The whole design is worked out in several scale steps till detail level.

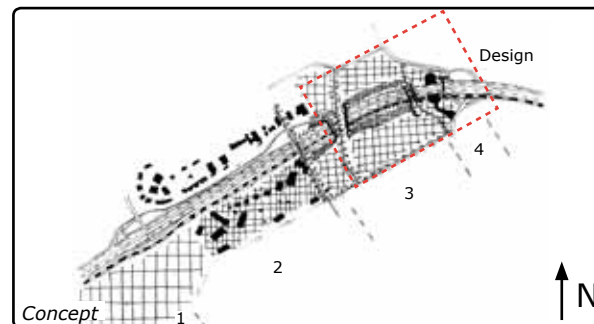
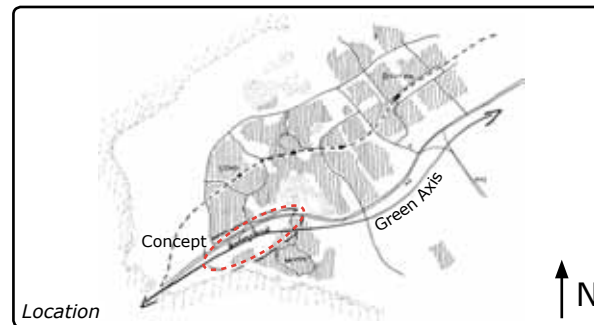

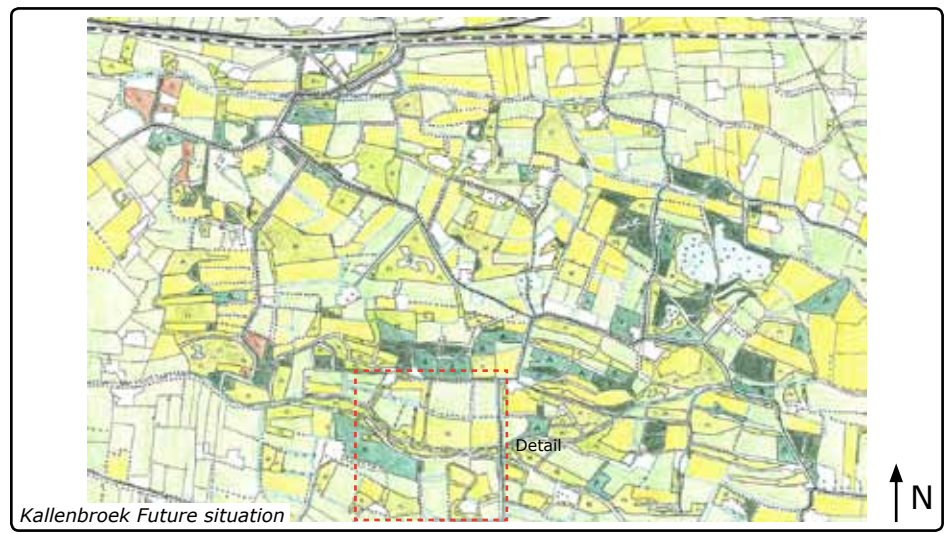
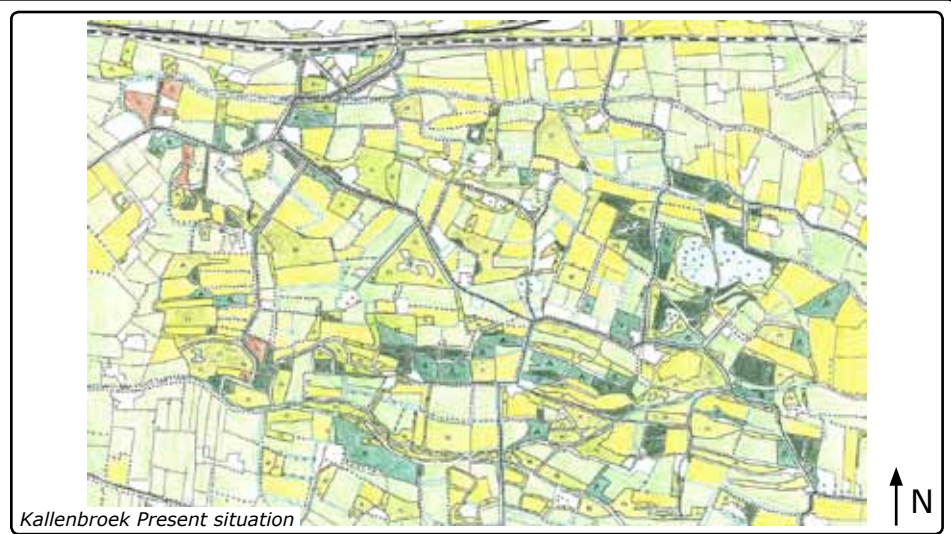
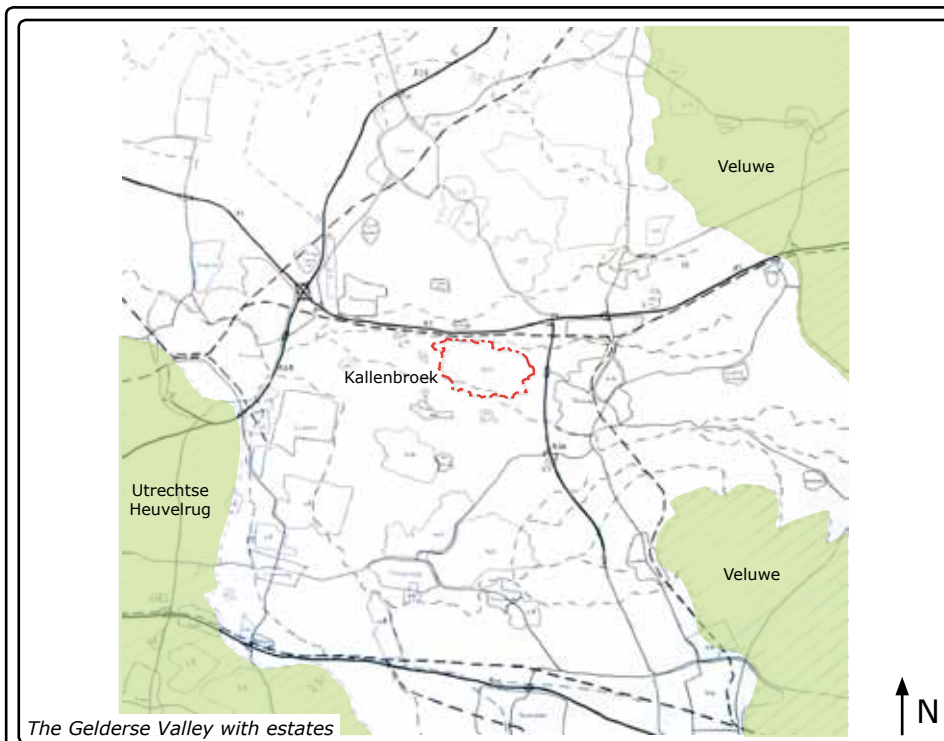

# Bachelor Thesis, Structural Vision for the Gelderse Valley

**Location:** Gelderse Valley, The Netherlands  
**Scale levels:** 1:200.000, 1:50.000, 1:10.000, 1:2.500 en 1:200  
**Language:** Dutch

For this project, which is between the Utrechtse Heuvelrug and the Veluwe, I first made a policy document in an integral working group, based on European, national and regional laws and policies, for business, infrastructure, living, nature, recreation, cultural history and landscape. For the landscape scenario based on the brook system in

the Valley, I made designs for new estates. Goal in design was to border further loss of the landscape structure and to preserve and recover this structure. This was combined with the addition of new functions such as housing, offices and other functions to gain income for the revitalization of the landscape. For one 'island' consisting of old landscape elements I strengthened the 'green' edges by masses, semi-mass and open areas. Furthermore I worked on the internal structure by new estates, nature preservation and the divisions between public and private.

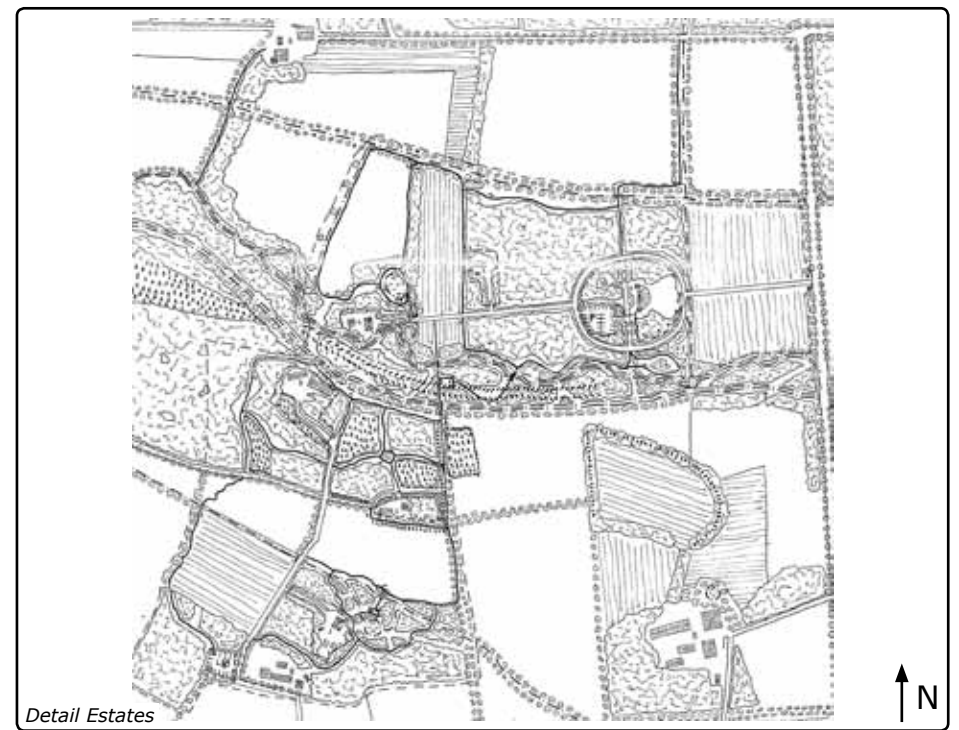

For my internship I choose a larger company, which has all the working fields related to Landscape Architecture integrated in their office and which did projects all over The Netherlands, although this headquarter was mainly focusing on the south and east of the country. I worked with experts on multiple aspects in the design assignments and did projects varying from low till high scale levels and from rural to urban. I worked in the office as well as outdoor for analysis, presentations and meetings with clients. Some of them I will briefly show in my portfolio.



## Town planning parcelling plan Harreveld

**Location:** Harreveld, Municipality Groenlo-Lichtenvoorde, The Netherlands

**Scale levels:** 1:5.000, 1:2.000, 1:500 and 1.100

For this pilot project for we planned new housing clusters as small rural dwelling units within the present town planning scheme. I worked on the whole process in design from analysis till execution plans. The new clusters are situated in a new green plan to preserve, to restore or to strengthen the identity of the village and the region.

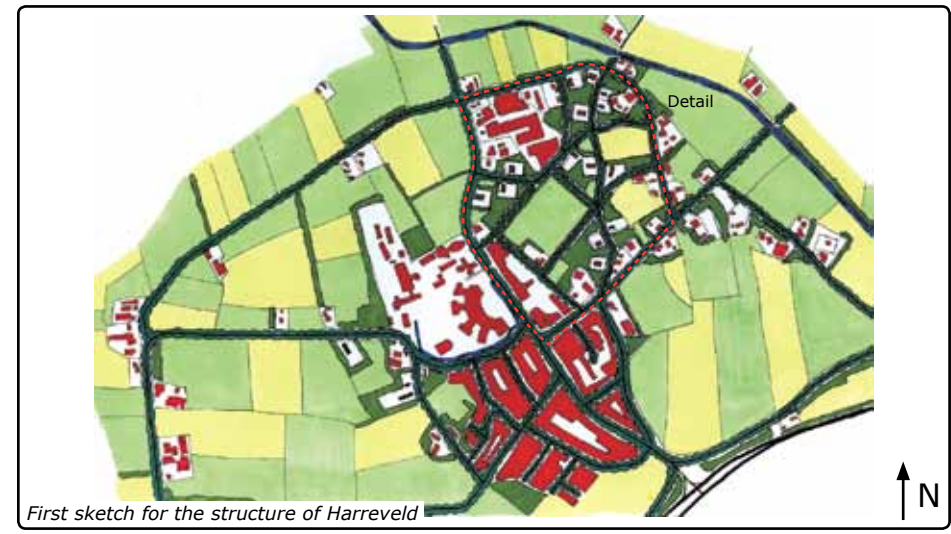

# Internship at BRO in Vught, The Netherlands

Urban town planning design vision for a housing location on an intensification site in Ulestraten

**Location:** Ulestraten (Municipality Meerssen) , The Netherlands

**Scale levels:** 1:500 en 1:100 and 3D perspective

For a sloped parcel of two hectares in Ulestraten I made a sustainable town planning design. This was characterized by preservation of history

(sight lines), water management (wadi's and infiltration areas), green (old fruit trees and green fencing), car movement, slow traffic, parking and energy (solar panels). This was incorporated in buffer areas, the housing program and the accessibility setup.



## Structural plan agricultural and food cluster in West Brabant

**Location:** The Old Prinslandse Polder at Dinteloord (Municipality Steenberghe), The Netherlands

**Scale levels:** 1:100.000, 1:50.000, 1:25.000, en 1:10.000

Two major companies in the area started a cooperation in sustainability. They re-use and share warmth, electricity, infrastructure, installations

and space. For this I made a green and blue network for the region and the local area. This incorporated location plans for all the drains and pipes, nature, a business park and glasshouse agriculture. This was all designed in a grid like setup from the polder landscape respecting the dikes and their new profiles, the A4 highway, which would be extended and the design within the cluster.



Historical Polder Grid



Present Polder Grid



First sketch Dinteloord setting

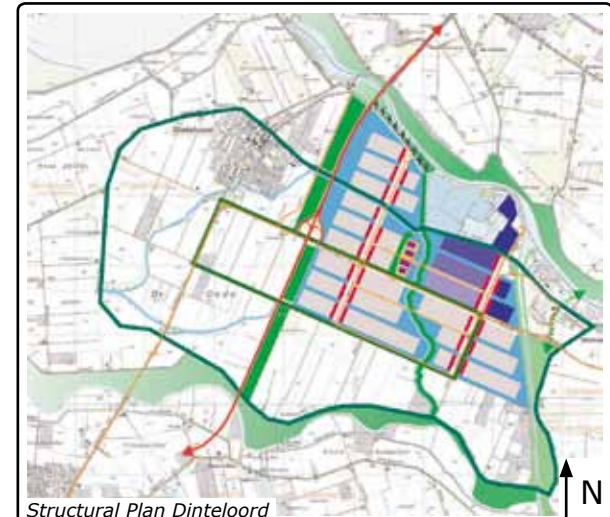

Structural Plan Dinteloord

# Internship at BRO in Vught, The Netherlands

Parcelling plan WEGA dwellings in Wijchen

**Location:** Wijchen, The Netherlands

**Scale levels:** 1:5.000, 1:2.000, 1:500 and 1:100

For this location in Wijchen we worked with WEGA-dwellings, which are prefab dwellings which can be used close to noisy highways. The main goal in the plan was to reduce noise pollution inside the houses as well as for the areas within the plan area. In the plan we made small dunes as

green barriers to the ring road. Within the plan is a brink (central green place), bordered by a wind mill hill, which suits the rectangular space where the ring road is crossing through. The south and west are for water storage and a neighbourhood garden is situated on an island to which only local inhabitants have access by a bridge leading from a 'castle' tower.

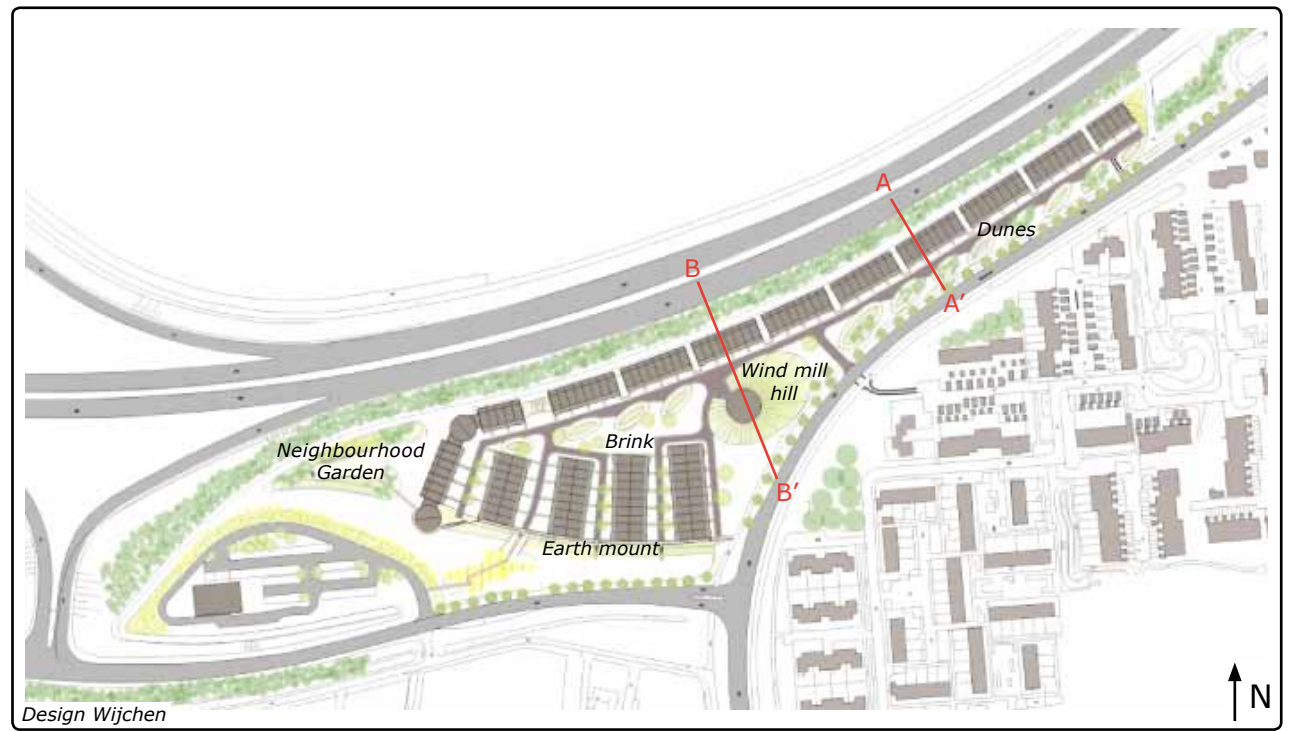
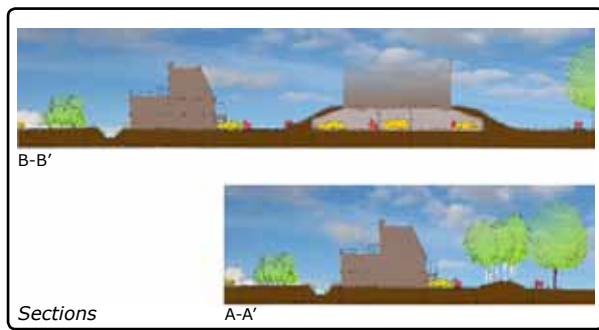

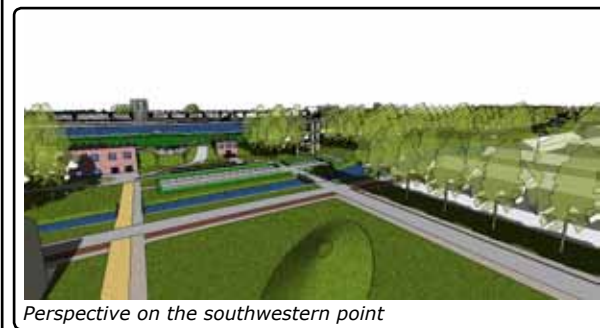
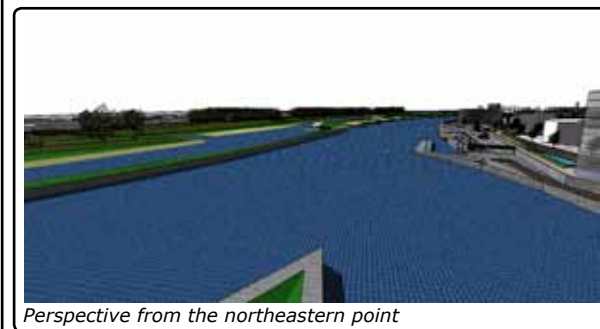
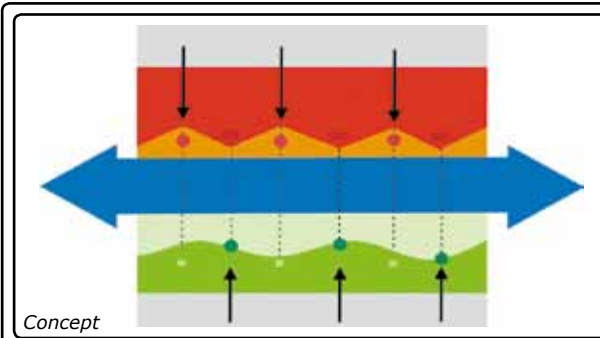

# Master atelier, Mirroring Opposites, Arnhem

**Location:** River edges including flood plains of the Nederrijn in Arnhem, The Netherlands  
**Scale levels:** 1:25.000, 1:5.000, 1:2.000, 1:500 en 1:200 en total 3D-Model in SketchUp  
Language: English

The main issue in this project was to deal with the Space for the River program. For this we did a research on regional scale level to distinguish different risk areas. I chose the narrowest space of the river in our project area, where the need for space for the river was most necessary and

where the two different city edges were closest to each other. My concept was based on faces, lines and points between the 'red' (city centre) and the 'green' (southern city expansion) sides of the river. The higher and lower faces had different functions along the ongoing river and several focal or attraction points were designed to strengthen sight lines or to guide people towards the river. These lines were extended in their backlands by streets or green strips. Furthermore I used different materials on the two sides to increase the contrast between the two water edges. For instance open versus enclosed planting, brick versus glass. A main focus point in the design was phasing the project and to guarantee a good feasibility for the execution.

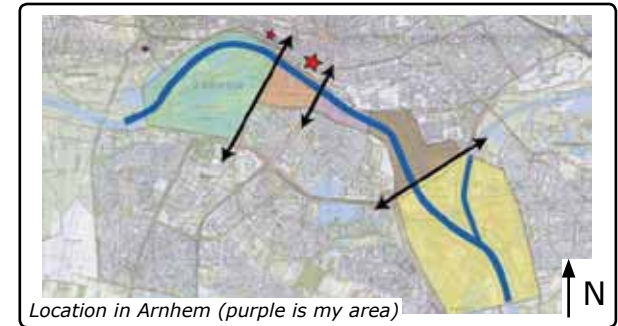

## Erasmus Exchange Program

In 2006 I studied at the Technical University of Munich in Germany. I mainly lived and followed classes in Freising, a city north of Munich. I specialized myself in Town Planning and feasible detailing of projects for execution. Furthermore I followed many courses such as history of Garden and Landscape Architecture. I got many friends there and followed all courses in the German language.

## Project L8, Bridge 'n square it!, Vienna

**Location:** Around the heightened A23 highway in Vienna, Austria

**Scale levels:** 1:80.000, 1:5.000, 1:2.000, 1:500  
en total 3D-Model in SketchUp

**Language:** German

The design area is located in the east of Vienna around the busiest highway in Austria. The highway is build on poles and gives a nice overview. The whole area was the former goods delivery part of the city and will now be restructured into a new business area.

My concept was based on different views from the highway perspective. Three squares were designed by our group. A red city square, an orange sports square and a green park-like square, which I designed. The space under the A23 was the connecting element between the squares. Since the urban context provided me with a more triangular shape, I made a green rectangular roof on the green plaza. This was a construction of steel which was planted with Wisteria climbing plants and



# Erasmus in Germany and Bridge 'n square it!, Vienna

connected to one of the old butcher halls of the site. This strict green net forms the 'upper world' of the plaza and contrasts with the 'under world' of sloped white concrete. This sloped area follows the existing topography and is shaped in terraces and water basins for water storage. Outside the raster area the park is designed with open green areas in which the former railroad tracks are incorporated as walking paths. The edges of the triangle are accentuated by Hippocastanum trees, the tree species of the city of Vienna.

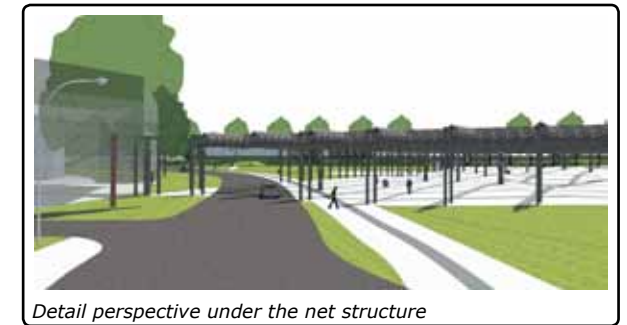
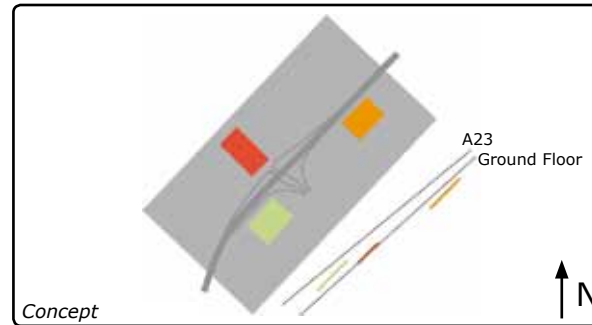



City of Eindhoven, City Part Woensel and District Woensel Noord

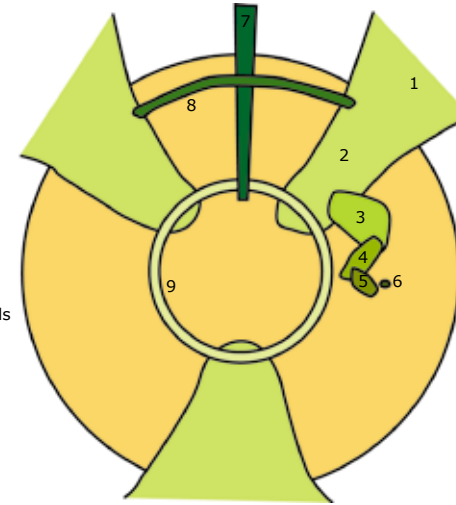

1. Outer Landscape
2. Green Lobe
3. City (Part) Park
4. District Green
5. Neighbourhood Green
6. Dwelling Green
7. Major Access Roads, Radials
8. Major Access Roads, Tangentials
9. Inner City Ringroad

Green Hierarchy

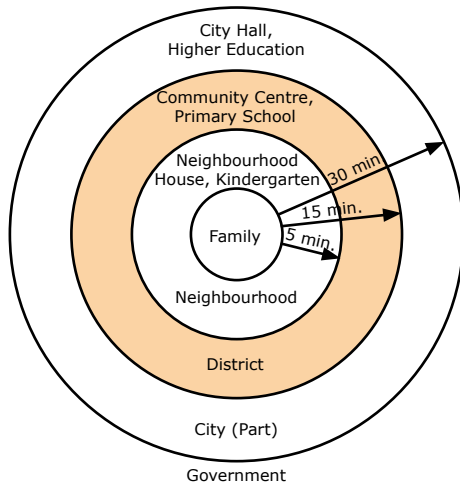

Town Planning Hierarchy according to the District/Community Thought

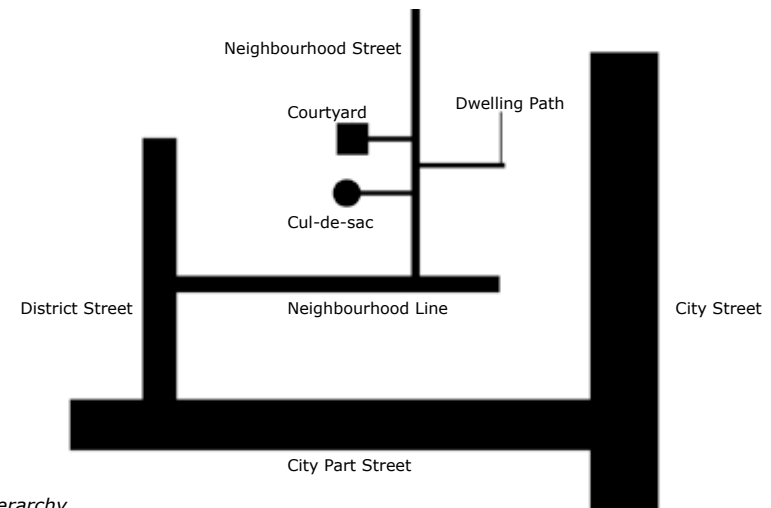

Traffic Hierarchy

# Master Thesis, More than just a facelift

Developing a landscape architectural vision for the restructuring of post-war dwelling areas in The Netherlands with a focus on cultural history

**Location:** Woensel Noord, Eindhoven, The Netherlands

**Scale levels:** 1:100.000, 1:50.000, 1:25.000, 1:20.000, 1:10.000, 1:5.000, 1:2.000, 1:1.000, 1:500, 1:250 and multiple 3D-models in Sketch-Up

**Language:** English



## General

As a final project in my study I wanted to integrate my gathered knowledge about Town Planning, Landscape Architecture, Cultural History and designing by Genius loci. I choose the subject of restructuring post-war dwelling areas, which nowadays is a hot issue. The districts built between 1945 and 1970 compose one third of the total housing stock in The Netherlands with a high percentage of green public space. They were built according to modernistic guidelines for architecture and town planning as well as for the landscape. By these base rules they all have rather similar looks and they can be found in any city in The Netherlands, but also abroad. To find a solution for bringing back local identity by the means of cultural history and design solutions was the main goal in my thesis. By this mean these districts

could again be distinguished from each other and provide a nice living environment for the next 50-100 years.

The main concept for these districts at their construction was the *Wijkgedachte* (District/Community Thought). Respecting the *Wijkgedachte* and with my vision of cultural history and the ongoing landscape as a base for my holistic approach, I worked according to five main approaches:

- Visions through the scale levels with a focus op de District
- Green hierarchy
- Traffic hierarchy
- Water hierarchy
- WAS to IS to WILL BE.

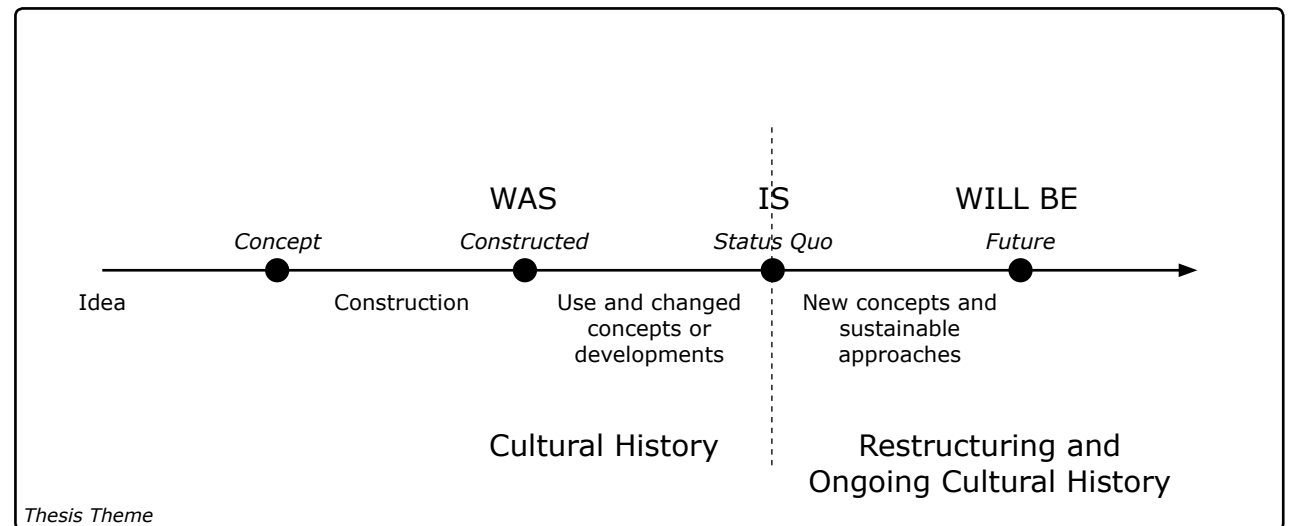

1. City Scale Water
2. City Part Scale Water
3. District Scale Water
4. Neighbourhood Scale Water
5. Local Scale Water



*The new hierarchical water system design principle*



# Master Thesis, More than just a facelift

Especially the WAS-IS-WILL BE storyline is dealing with the past cultural history, but also respecting the future ongoing cultural history as it will develop in time. Because in my opinion not just the architecture and landscape changed in time, with its transitions and divisions between public, private and semi-private green areas. But also the *use* and *experience* of areas by inhabitants or developments in *society* and in the *demography* in districts and neighbourhoods changed in time.

The base from my approach was to develop a vision on different scale levels in the city of Eindhoven, my project area. For every scale level I respected the original concepts of which I gathered the information by intensive (reference) studies. This was also essential to bring all stakeholders together, which are participating in restructuring projects. Then restructuring would be done in an integral method and holistic actions instead of incidental adjustments could be insured, next to reducing costs and enlarging the quality of changes. Therefore my main approach is *Preservation by development* described by the motto:

## More than just a facelift

My vision deals with offering better, recognizable living environments providing identity and therefore Genius loci to these straight forward, green but rather 'boring' districts. The old waterways from Eindhoven will be a base for my new approach in the orthogonal structured district. This new water layer will be shaped in hierarchical wadi systems, which will solve the water problems in the area in a sustainable way, by slow decoupling.

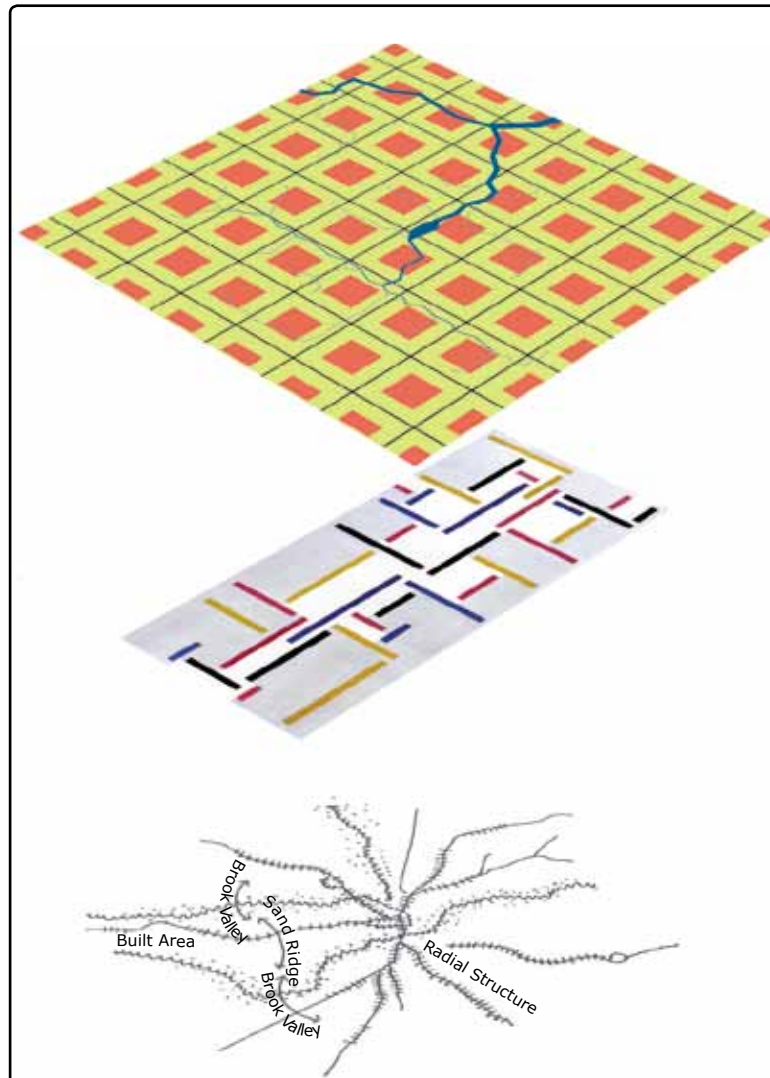

Thesis Motto

I introduced a new water system in the orthogonal structured districts, which is inspired by the former hierarchical brook systems, but shaped in a new form language since just digging up the disappeared waterways is impossible in the orthogonal structure and also not suiting this strict setup

The districts which are built according to the *Community Thought* were inspired by orthogonal patterns of paintings of the Modern Movement in the art world. In this case a Van Doesburg painting, called the *Russian Danser*

The old geographical structure of Eindhoven with valleys of hierarchical brooks between the higher sand ridges on which the first settlements were built in a radial pattern following the brooks



Master Plan WAS situation

# Master Thesis, More than just a facelift

## *Design*

After my thorough research in general and on the city of Eindhoven I developed several hierarchical design principles regarding traffic, green and water, focusing on function as well as on materials (see report). These principles with sustainable as well as historical approaches focus on the public space and the division of or the transitions between public and private areas in the urban field of Woensel Noord. By these principles for design as well as maintenance and my research I made three Master Plans of the IS, WAS and WILL BE situations.

In the Integral Design Green Cross I integrated all working fields of traffic, green and water on all scale levels in the internal green/blue network of my district. This green/blue network also functions as recreational network and is a framework for centres, new functions and a connection to the surrounding landscape. Furthermore I made Schemes for Outdoor Spaces and Profiles for all roads in my district to enlarge orientation, differentiation and recognition to a per scale level assigned road type (for all typologies see report). For every road type my design principles for traffic, green and water are specified to distinguish types from each other.





# Master Thesis, More than just a facelift





*The City Street Kennedylaan WAS situation in 1975*



*The City Street Kennedylaan IS situation in 2006*



*The City Street Kennedylaan WILL BE situation perspective*



*The City Street Kennedylaan WILL BE situation section*

# Master Thesis, More than just a facelift

For the last scale level of the neighbourhood I also made redesigns for major green strips which are clarified by schematic 3d-models. Each part within the neighbourhoods got its own species of hedge for the transition from public to private to distinguish itself in the area. In this case for the neighbourhood Woenselse Heide I also add new architecture and one can see the local scale water management.



*Bird's eye perspective from the park towards the flat*



*Detail perspective of the central neighbourhood collection pond*



*Design for a neighbourhood green strip with small scale water decoupling in Woenselse Heide*

## Hollandia Lil Bi'a in general

In 2010 I moved to Riyadh, the capital of the Kingdom of Saudi Arabia. I worked there for Hollandia Lil Bi'a, a company dealing with Master Planning, Landscape Architecture and Architecture. The company is owned by two Dutch people. In the company we worked with a small team of around 10 persons with varying nationalities from the Philippines, India, Eritrea, Ethiopia and The Netherlands. In this period I got familiar with a totally different culture than the European one, a hot climate, another language, different demands by clients and I enlarged my knowledge in computer programs. Since Landscape Architecture is still a rather new business in the Kingdom, our company also saw itself as a tutor to the clients to open their eyes for European Landscape Architecture. We worked with concepts before de-



sign, which was often quite new for clients, but more and more highly appreciated. Our office did mainly projects on the east coast of The Kingdom of Saudi Arabia.

My main tasks in the company were designer Landscape Architect and Project Manager. As a designer I deepened out my knowledge about different planting and designing till precise details regarding Landscape Architectural as well as Architectural elements. Next to this data collection is quite different than in the EU, since often data such as maps or its management is lacking. As a project manager I learned a lot how to deal with the different people in my production team as well as how to deal with the financial aspects of the projects. I was one of the spokesmen regarding the projects and had regular meetings with clients as well as contractors about the execution of our projects. Although things in general go rather slow in the Kingdom of Saudi Arabia, because of the warm climate, the process from signing contract to design to execution goes rather fast. Sometimes the order for design till finalizing execution only takes six months. I was approached by the company as a Wageningen high scale orientated designer and would work on a large Master Planning Project. Unfortunately this project did not continue after our proposal and therefore my job was terminated.

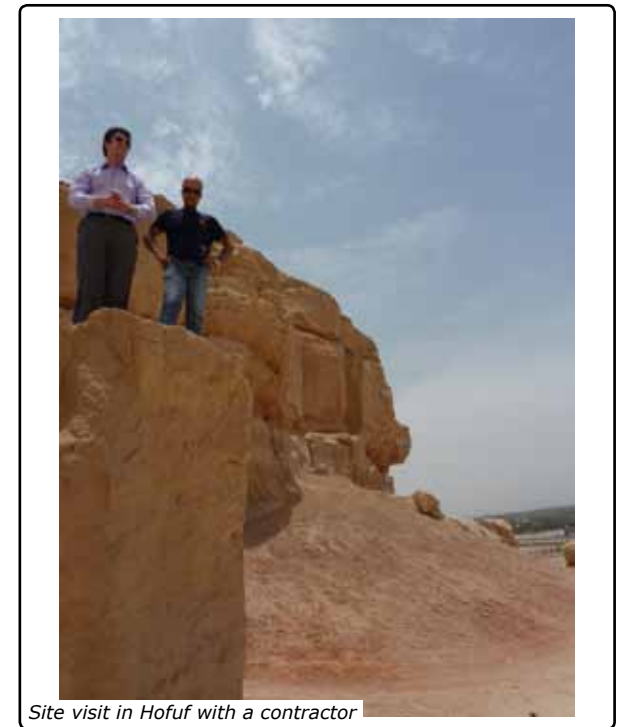

# Dammam Parks Design

## General

**Location:** Dammam, Kingdom of Saudi Arabia  
**Scale levels:** Varying from 1:1.000 till 1:10  
**Language:** English

In Dammam we did a lot of projects assigned by the Municipality since we had good contact with two deputy mayors there. Especially the one for the urban and landscape development with whom we wanted to develop numerous parks. We introduced overall returning elements, which would form a base for the identity of Dammam. In this project we instituted identity elements such as the five species of Dammam trees, the special Dammam bench and standard toilet buildings, kiosks and pavilions. Also natural wooden playscapes were introduced in contrast to all the plastic pre-fab ones, which one can find all over the coun-

try. Some elements which also return a lot in the parks were more connected to the client's wishes, such as boulevards and soccer fields. Every park was connected to the name of the district where it was located. This name was the base for the theme, concept and design of each park, respecting its urban context. Therefore we could distinguish the parks/plaza's/gardens from each other. After the designs were approved we also made fully detailed documentation sets for all the parks. This project went in a rapid speed and some of the parks are now already executed within a total of six months from assignment till execution.

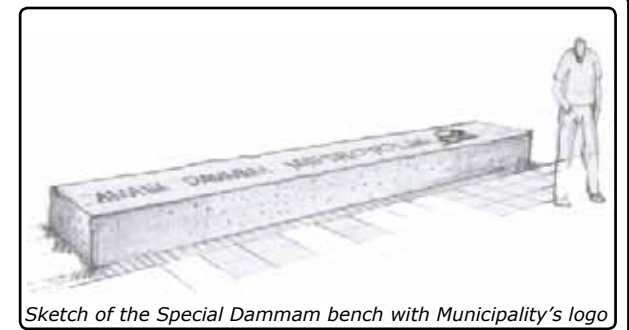

Sketch of the Special Dammam bench with Municipality's logo



Location in the Middle East

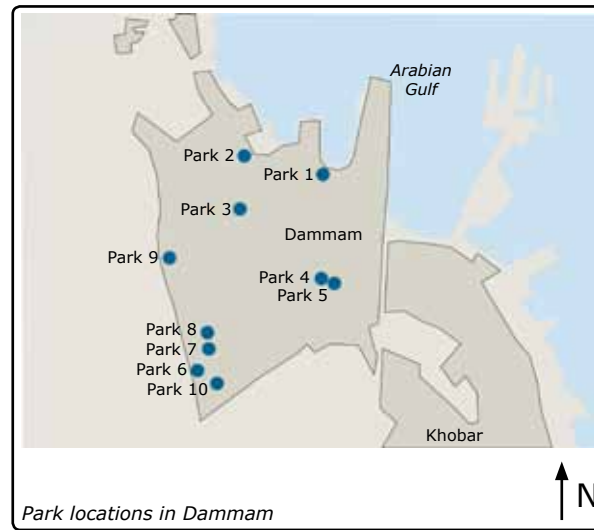

Park locations in Dammam

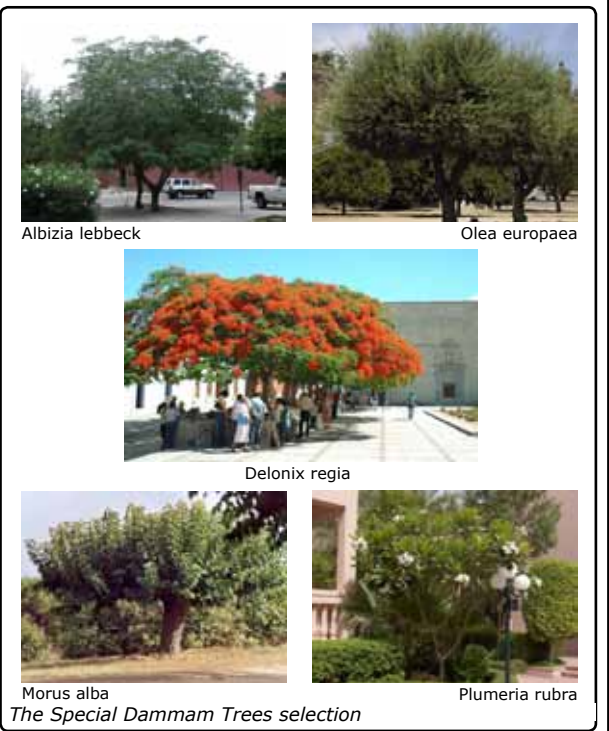

The Special Dammam Trees selection



# Dammam Parks Design

## Park 1 Al-Salam Park

*Size*  
15060 m<sup>2</sup>

*Theme*  
Park of peacefulness.

*Concept*  
The conceptual approach is to design a place where visitors can escape from the turbulence of their daily routines. The park is to become a secluded island in a rough urban sea.

*General Program*  
The park will mainly focus on families and has a strong division between the active part and passive part surrounded by earth mounts.



*Bird's eye perspective Al-Salam Park*

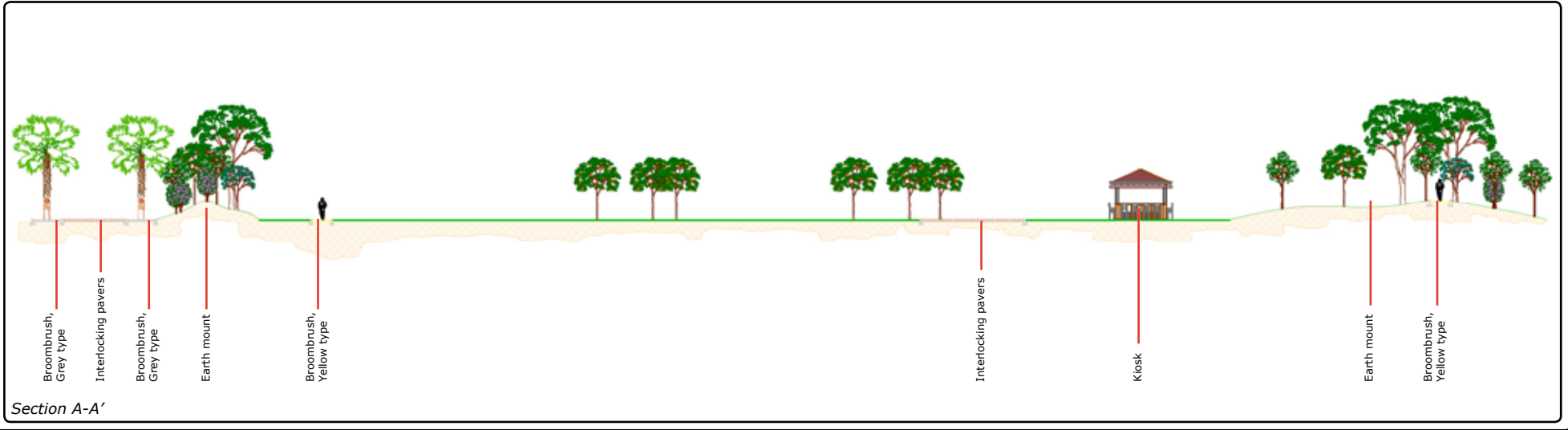

*Section A-A'*

Hard/Soft  
Landscape  
50/50 %

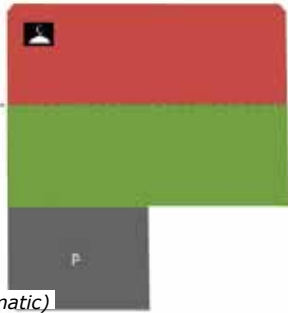

Concept Hard/Soft (schematic)

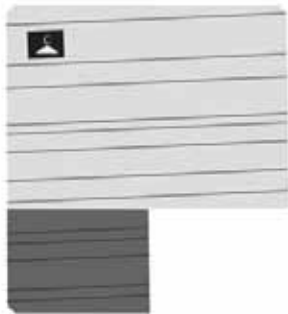

Concept Lines to Mekka

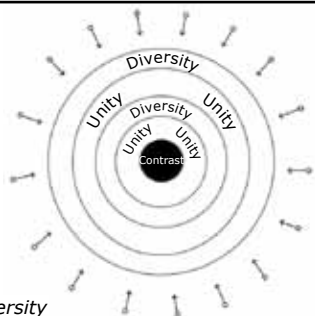

Concept Unity versus Diversity



Design Al-Muhamadiyah Park (Q = Mekka)

# Dammam Parks Design

## Park 2 Al-Muhamadiyah Park

For this park our area was just the green park in the east, but we were asked to incorporate a design for the plaza in the west, although this will maybe not be executed.

*Size*  
10005 m<sup>2</sup>

*Theme*  
The principles, beliefs and legacies of prophet Mohammed.

*Concept*  
The conceptual approach for this park is "Unity & Diversity". Although we are different in race, background and in culture, yet we stand united under one sun.

*General Program*  
The unity in our design is shown in the layout, while the diversity will be defined in our use of different materials. Activities for all groups of society will be present.



Bird's eye perspective Al-Muhamadiyah Park

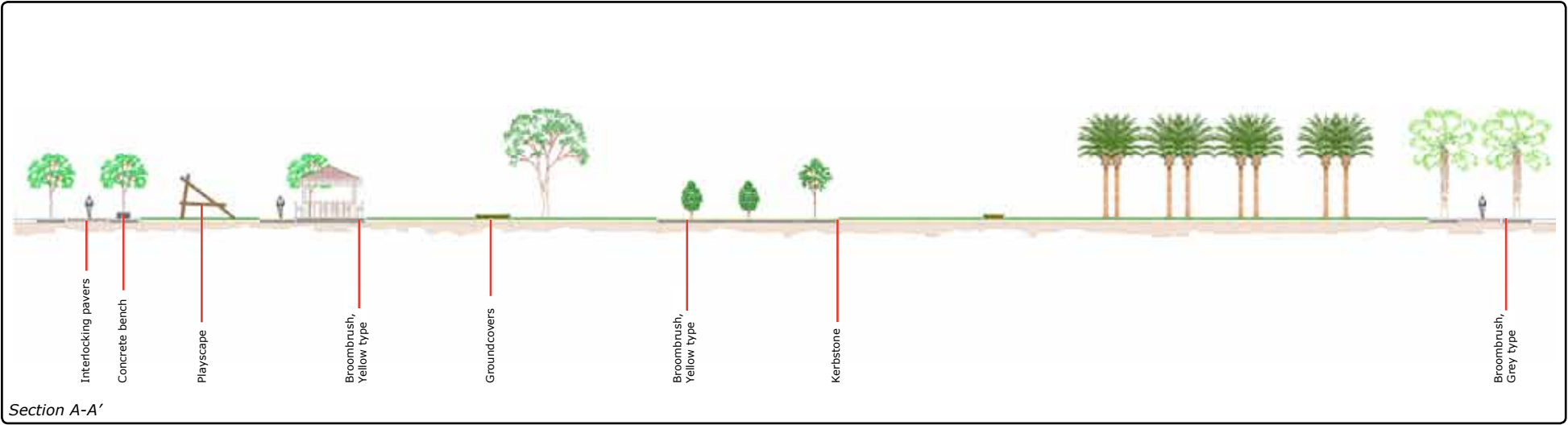

Hard/Soft  
Landscape  
70/30 % of  
most is vertical  
green

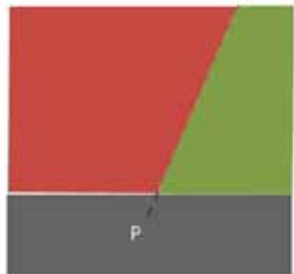

Concept Hard/Soft (schematic)



Area Schedule



Design Al-Atheer Plaza

# Dammam Parks Design

## Park 3 Al-Atheer Plaza

*Size*  
4684 m<sup>2</sup>

*Theme*  
Plaza of the artists.

*Concept*  
The conceptual approach is to create an international art display for all walks of life, without any cultural boundaries.

*General Program*  
Since this plaza is a more commercial area we proposed more hardscape as a plaza instead of a green park. Art will be zoned in several parts in the park, varying from graffiti walls till art exposition areas and each of these zones will be high-

lighted by a different species of special Dammam trees. In the centre of the plaza we place moveable planter boxes, so this area on the plaza can also function as an event square.

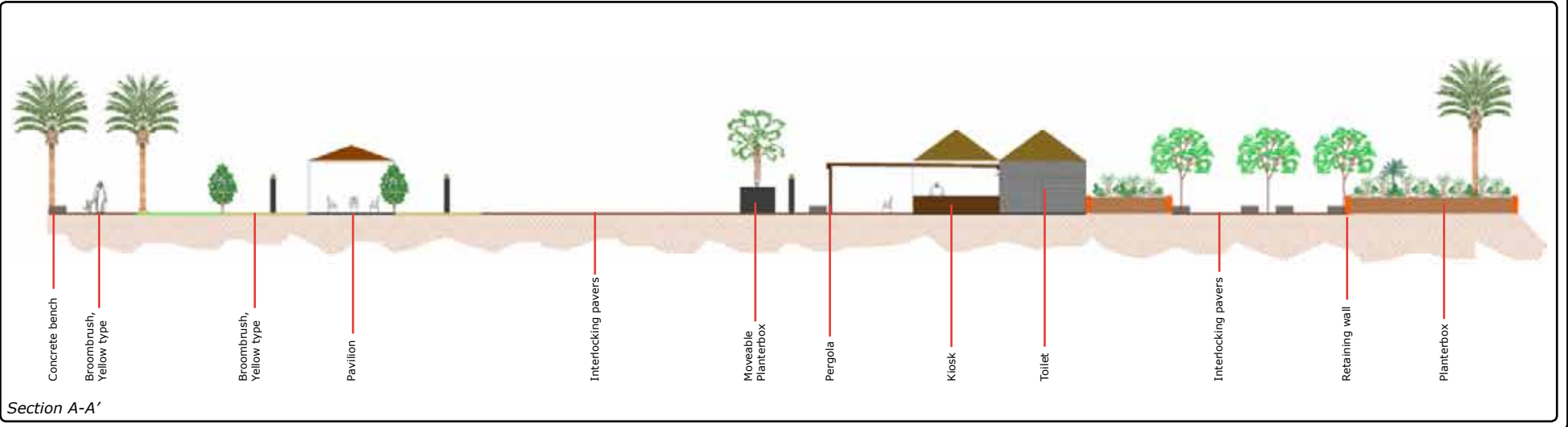
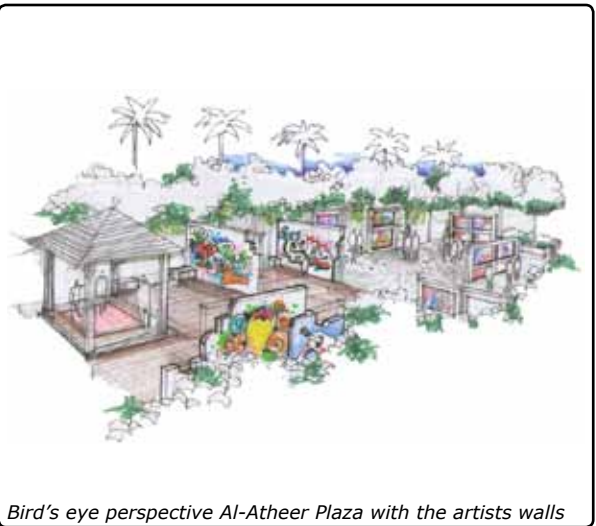
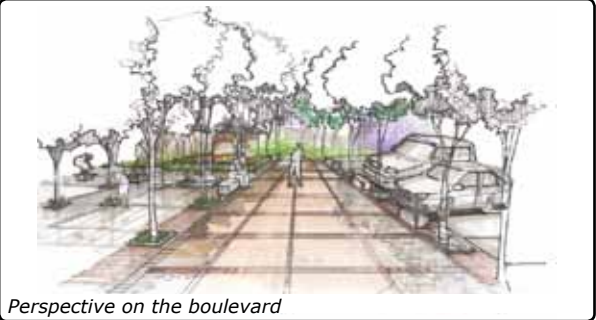

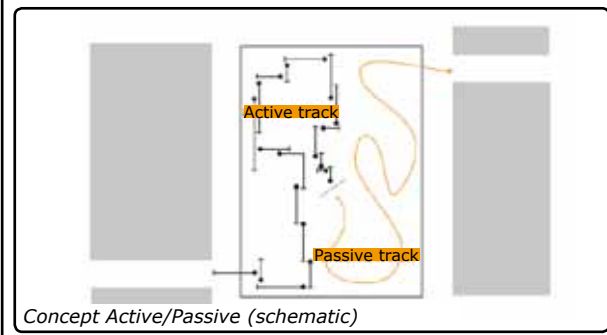
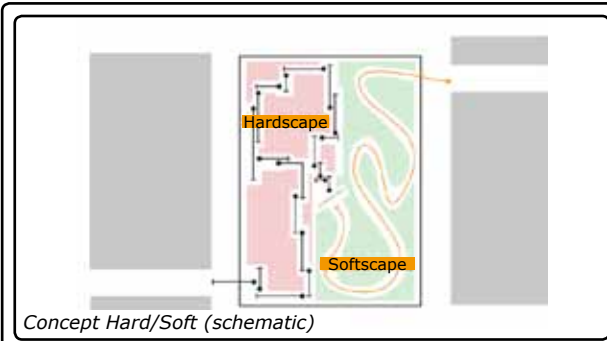

# Dammam Parks Design

## Park 4 Al-Rayan Garden

*Size*  
7330 m<sup>2</sup>

*Theme*  
Rayan, a gate of heaven.

*Concept*  
You can only reach Rayan when you follow the fixed path that will lead you there. On this path you have to overcome many difficulties.

*General Program*  
The gates of heaven are shape by hedges with tunnels in it. They are located at the entrances as well as in the park itself. By the location of the hedges one always has to turn around them to follow the route.

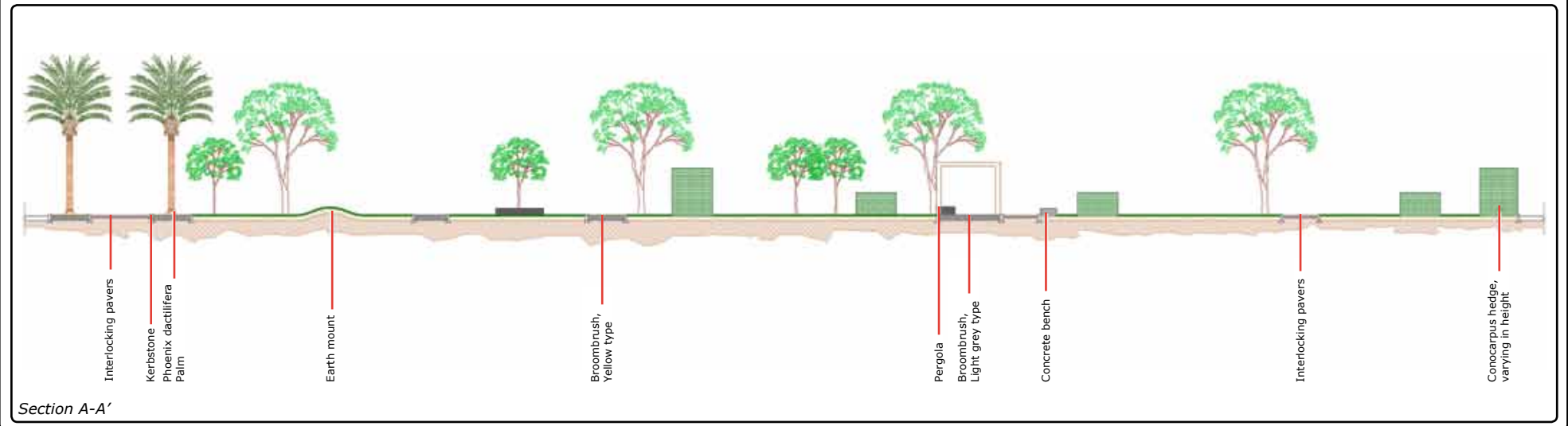

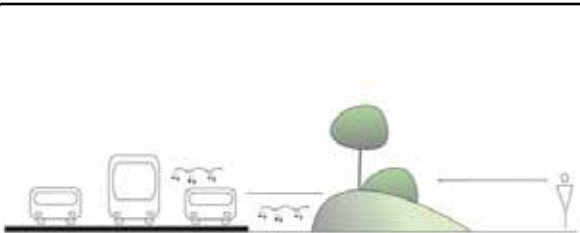

Concept noise reduction and visual barrier by earthmounds



Sitting arena



Chair icon

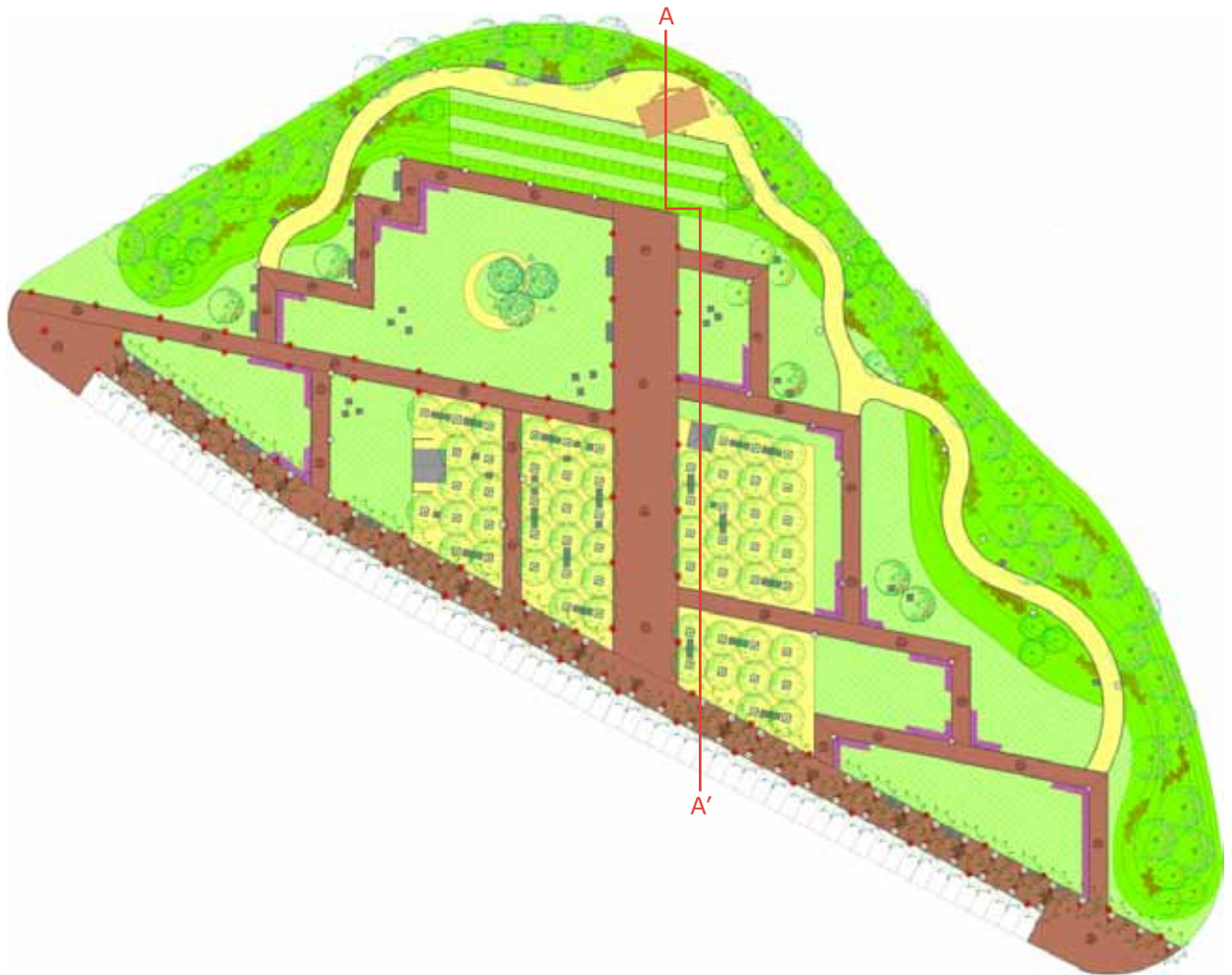

Design Al-Jamien Park

# Dammam Parks Design

## Park 5 Al-Jamien Park

*Size*  
13734 m<sup>2</sup>

*Theme*  
Scholars.

*Concept*  
The conceptual approach is to create a landmark that shows the uniqueness of each scholar.

*General Program*  
This park is located at a very dangerous, busy and noisy traffic junction. Therefore the main element is a large earth mount blocking most of the noise and pollution, while the open part faces the schools. The whole park will visually attract people and functions as a landmark. Central in

the park there is a grass sitting arena. Just a few functions will be installed to make it a quiet oasis versus the noisy schools.

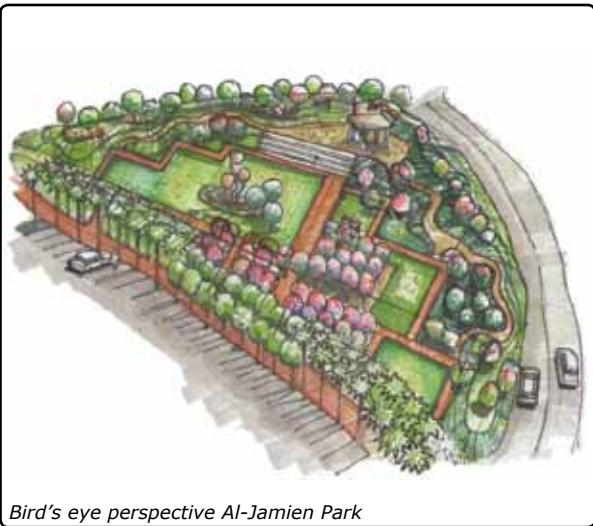

Bird's eye perspective Al-Jamien Park

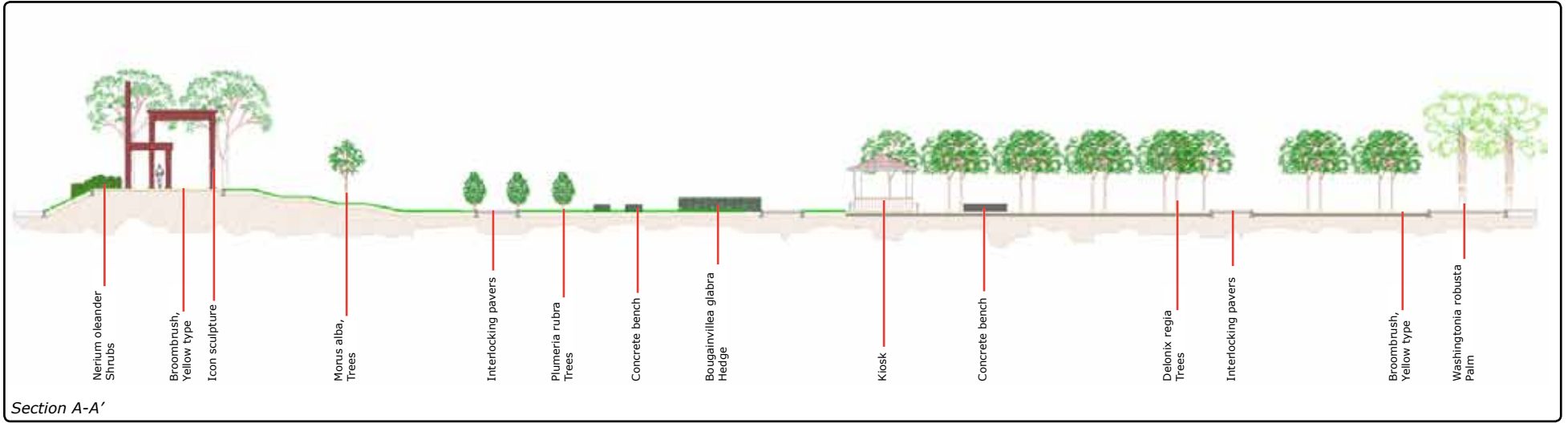

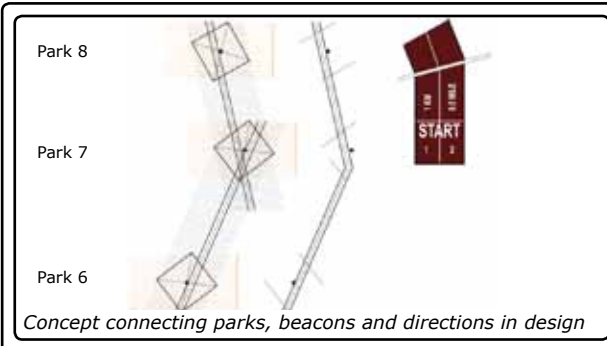

# Dammam Parks Design

## Park 6 Al-Manar South Park

Parks 6, 7 and 8 lay in the same district and were designed as a trio with a common concept and design elements, but varying fill-ins and visitor orientation of the parks. Common elements are the jogging track (later to be connected between the parks), the more active, open lower and more passive, shaded higher terraces, directions to the sea by paths and/or trees, sitting platforms, the surrounding boulevards and the beacons in the centres with varying heights.

*Size*  
4875 m<sup>2</sup>

*Theme*  
The course of finding oneself , while Manar means beacon, the main element in the parks.

*Concept*  
A continuous path that is connected through all three parks to create a functional relation.

*General Program*  
The Beacon Park South is strongly focusing on outdoor sports for mainly the youth. Multiple sports are present on the two terraces in the park, packed in a path structure with their direction to the sea.

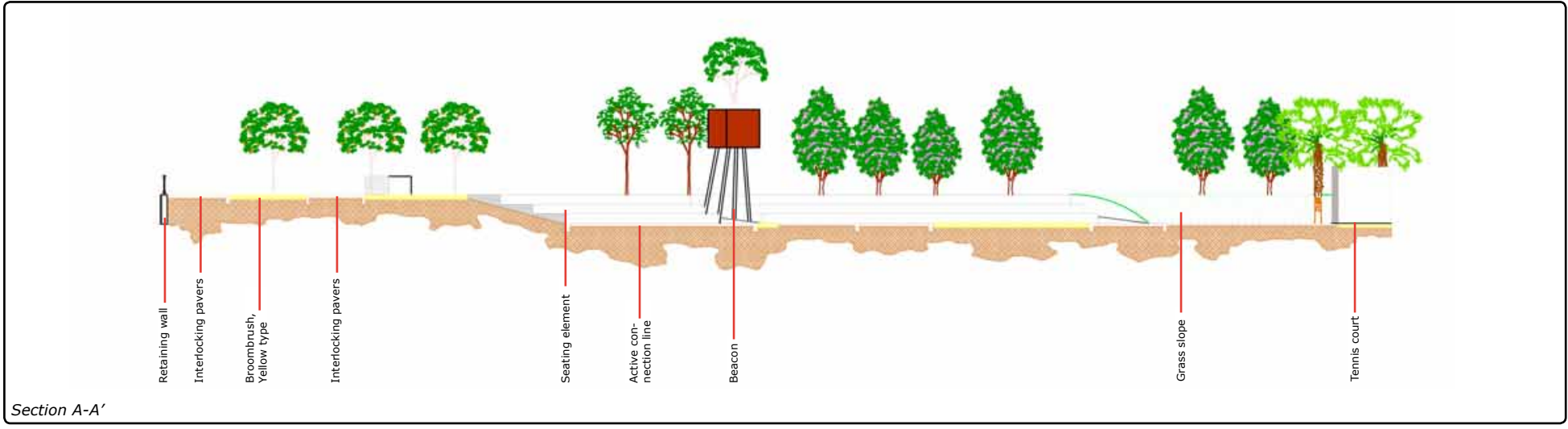



Impression beacon

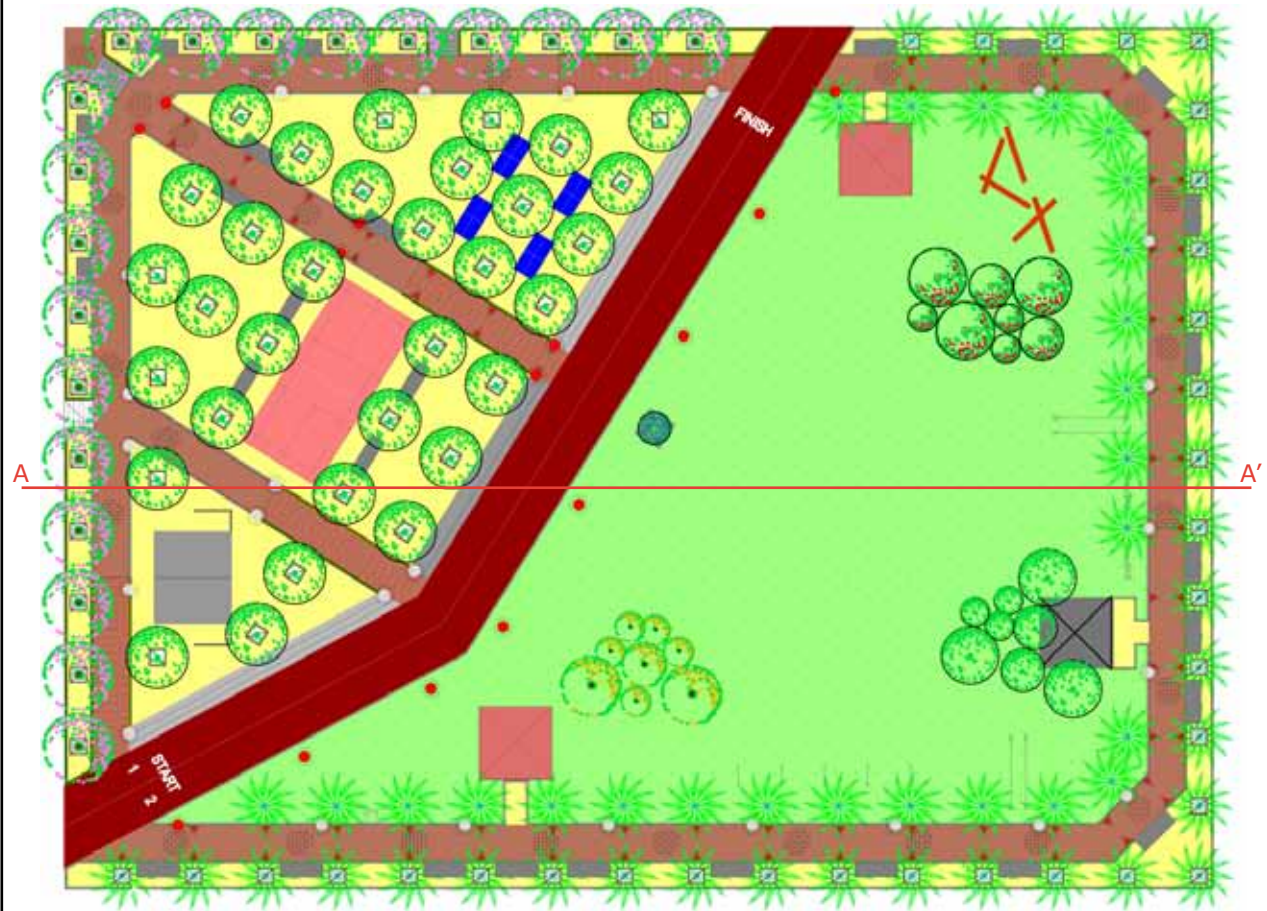

Design Al-Manar Central Park

# Dammam Parks Design

## Park 7 Al-Manar Central Park

*Size*  
4703 m<sup>2</sup>

*Theme*  
The course of finding oneself , while Manar means Beacon, the main element in the parks.

*Concept*  
A continuous path that is connected through all three parks to create a functional relation.

*General Program*  
The Beacon Park Central focuses on exercise possibilities and is designed for all age groups. The upper terrace is left open as much as possible as a plaza with tree lines towards the sea. This park has the highest beacon.



*Bird's eye perspective Al-Manar Central Park*

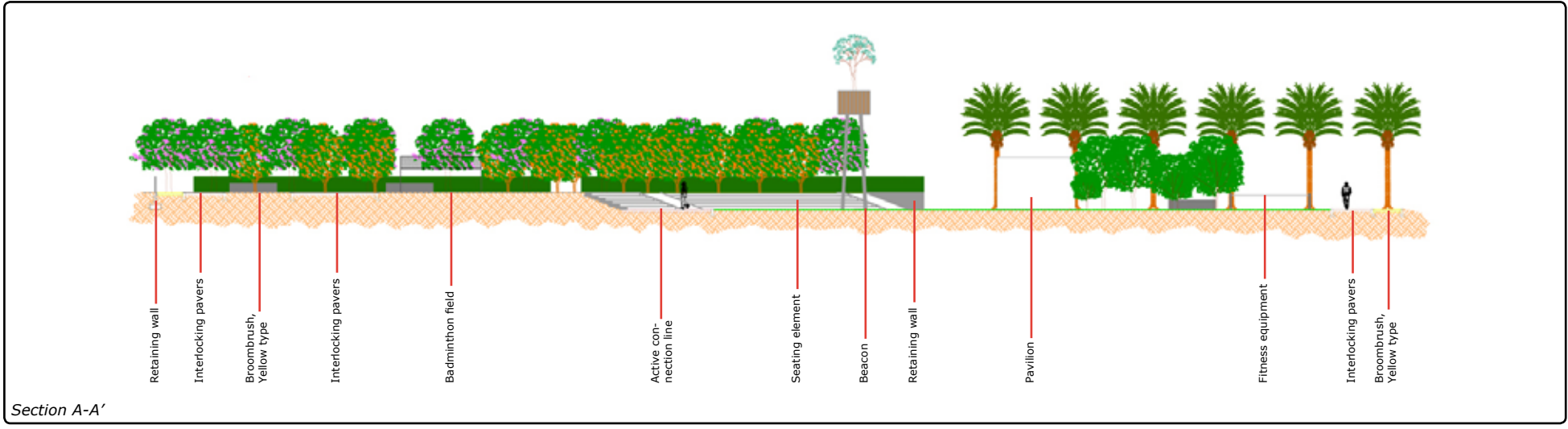



Impression seating element



Impression boat playscape

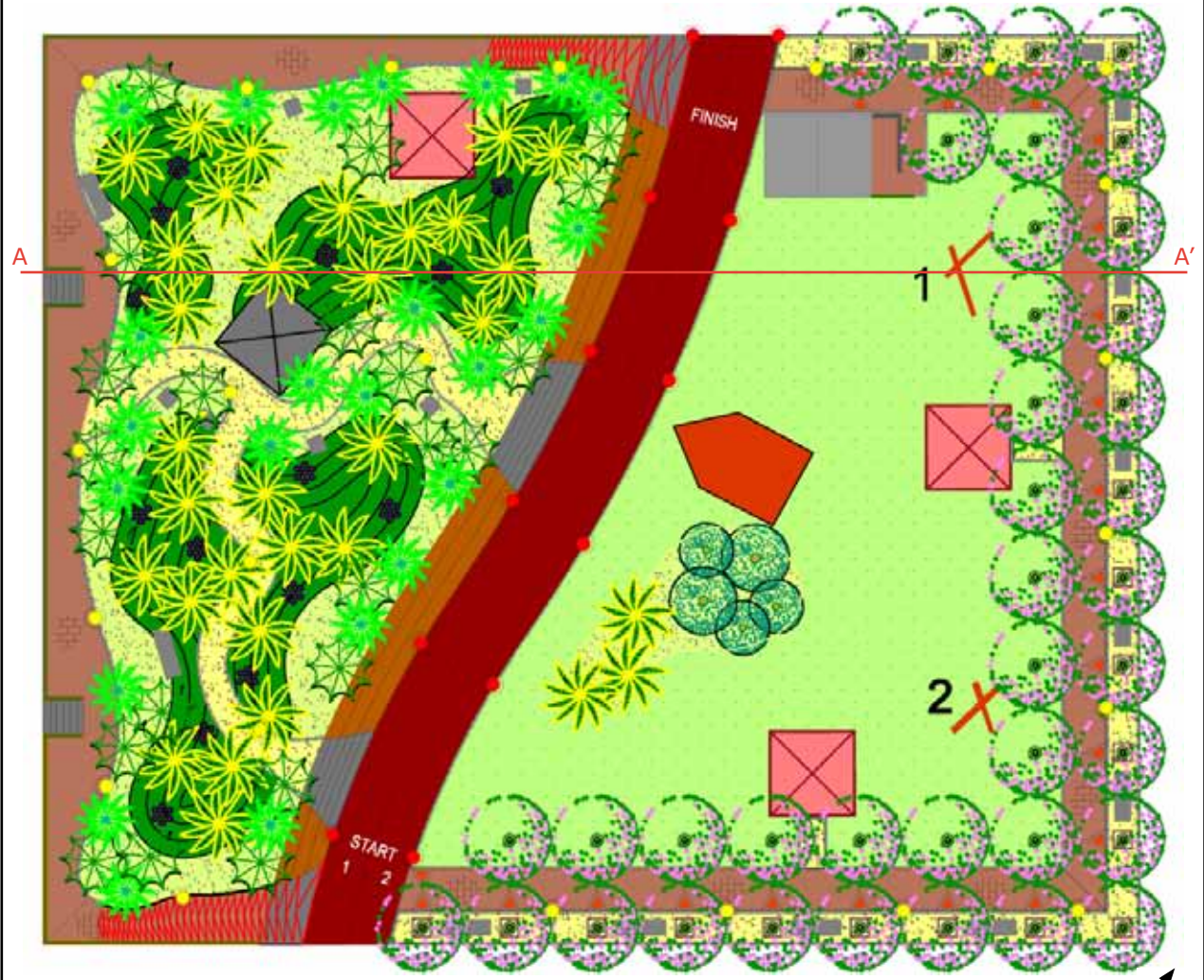

Design Al-Manar North Park

# Dammam Parks Design

## Park 8 Al-Manar North Park

*Size*  
3515 m<sup>2</sup>

*Theme*  
The course of finding oneself , while Manar means Beacon, the main element in the parks.

*Concept*  
A continuous path that is connected through all three parks to create a functional relation.

*General Program*  
The Beacon Park North is the smallest park of all three. It is focuses on relaxation for the family. The beacon is here shaped as an 'island' in the open grass plain.

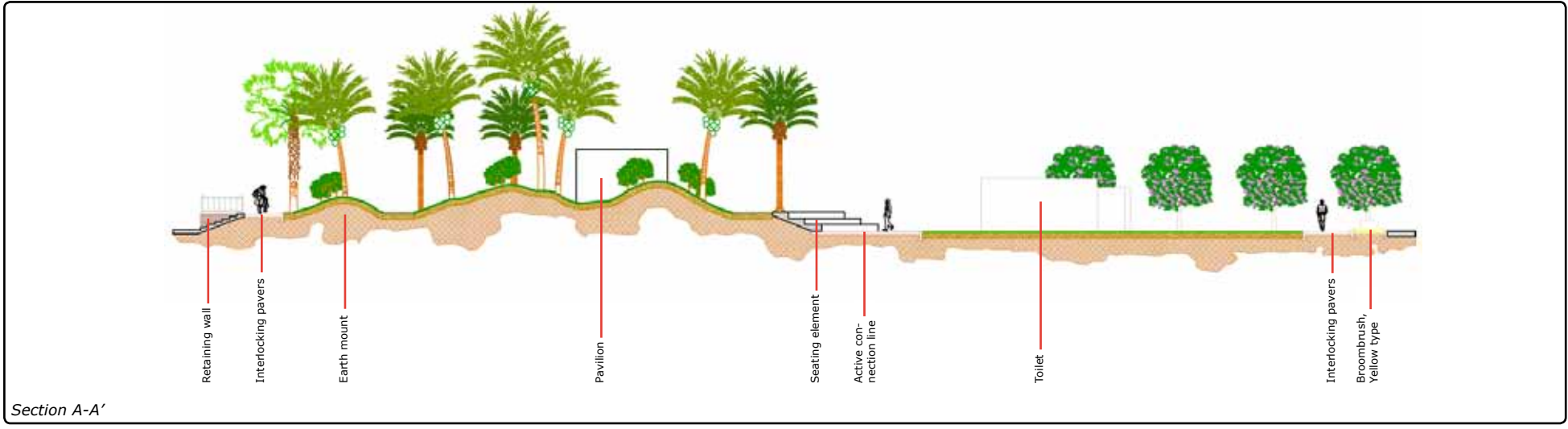



*Impression gabion wall*

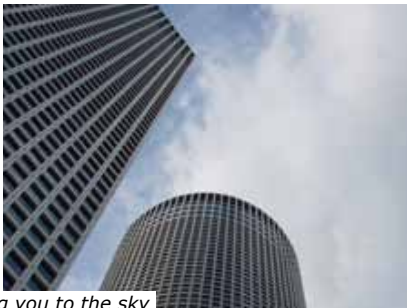

*Structures guiding you to the sky*



*Sundial*



# Dammam Parks Design

## Park 9 Al-Badr Garden

*Size*  
3138 m<sup>2</sup>

*Theme*  
The theme is inspired by the full moon, as it casts a great shadow of harmony & romance.

*Concept*  
The conceptual approach is to create a romantic garden where on can enjoy the beauty of the sky.

*General Program*  
This is the smallest park of all ten and located next to a mosque. The main orientation is towards the sky, so a large laying meadow is a podium to the sky where you get directed to by the minaret. The minaret is a link to its religious setting and also

functions as a sundial. The family garden is well bordered for privacy by gabion walls and earth mounts.

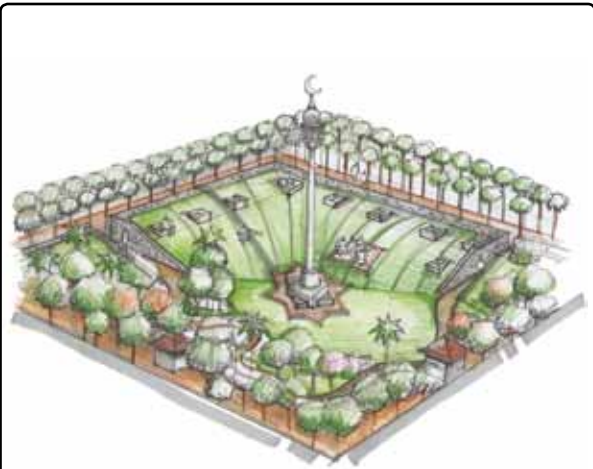

*Bird's eye perspective Al-Badr Garden*

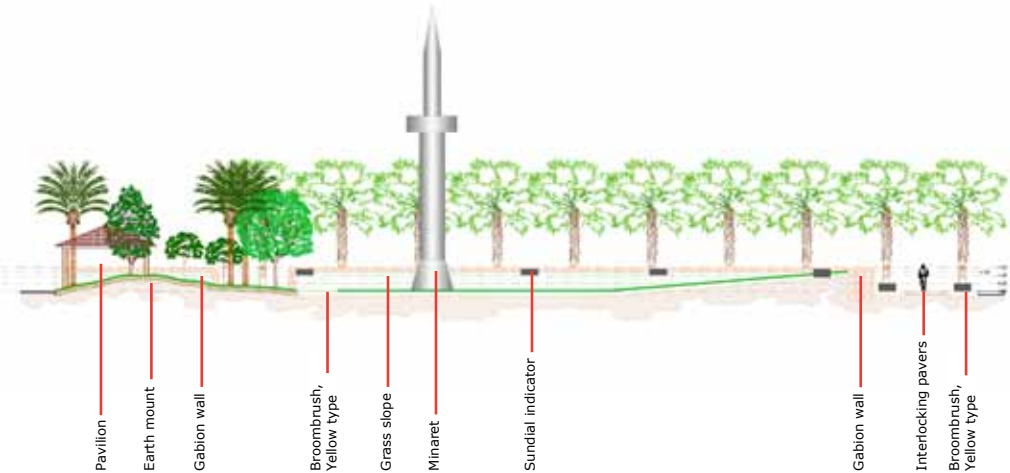

*Section A-A'*

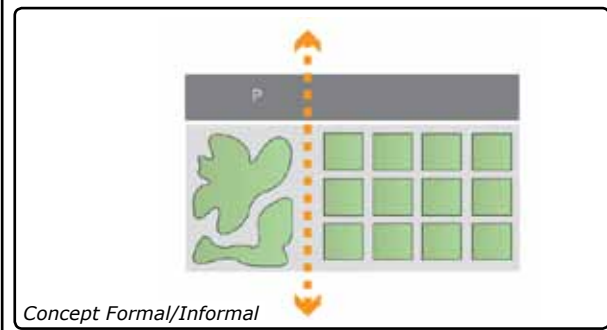
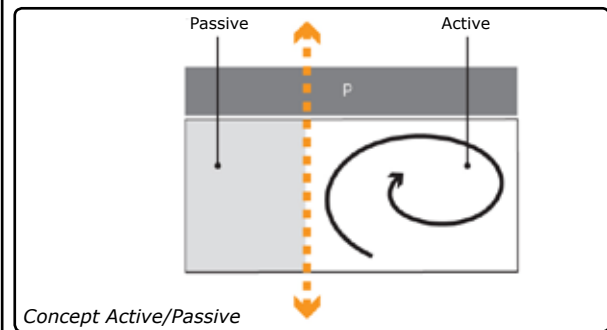
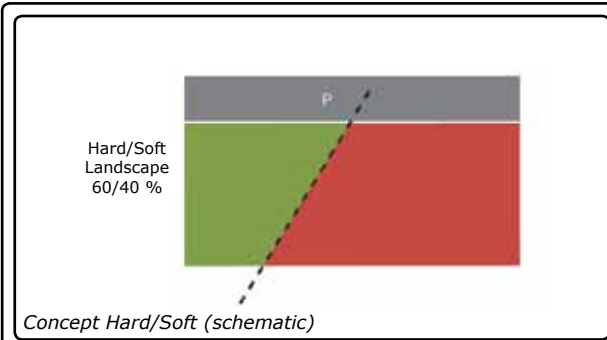

# Dammam Parks Design

## Park 10 Souk Taiba Park

*Size*  
6490 m<sup>2</sup>

*Theme*  
Taiba market.

*Concept*  
The conceptual approach is to design a dynamic gathering park with possibilities for a souk. The park has to become an international and multicultural gathering place, just like Taiba.

*General Program*  
This park is clearly divided into two parts. A relaxation area versus a market place which are separated from each other by a boulevard, which visually connects two streets. The market place is

bordered by planter boxes and has many trees to provide shade and coolness on the plaza.



*Bird's eye perspective Souk Taiba Park*

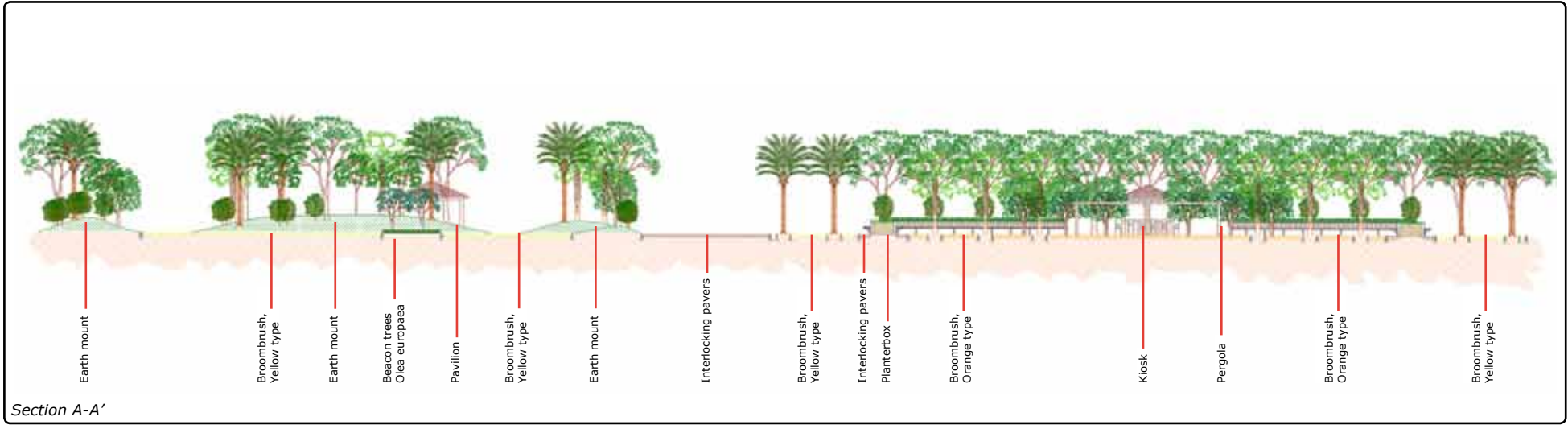

*Section A-A'*

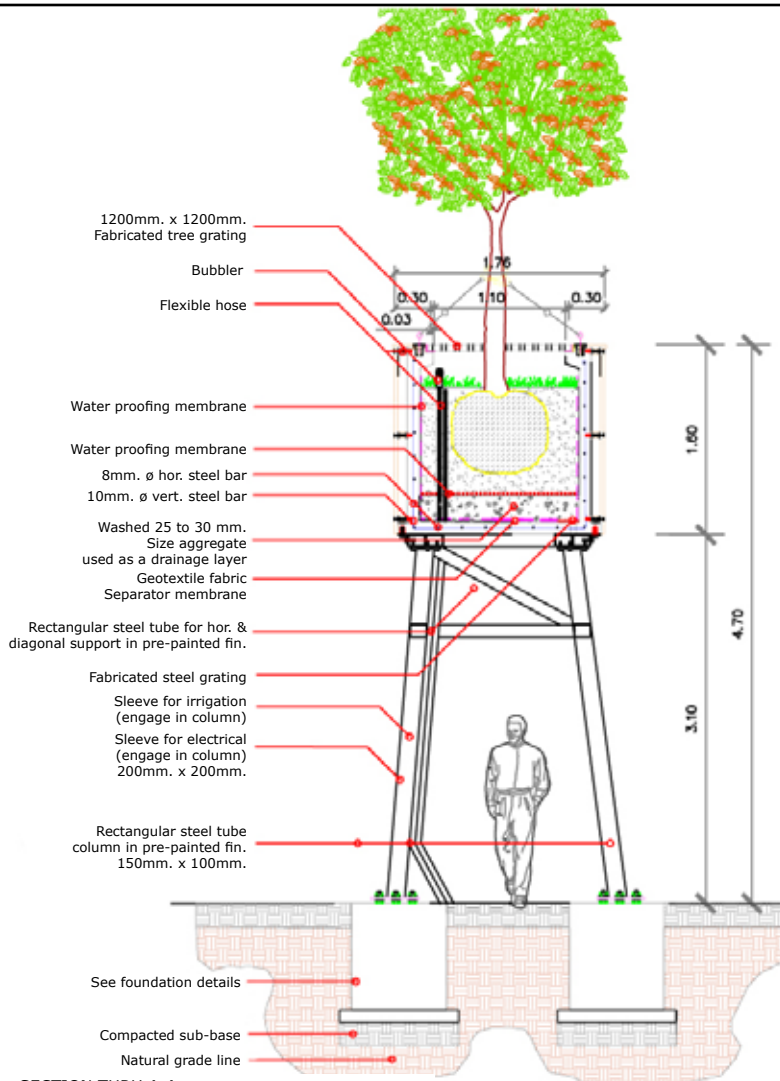

SECTION THRU A-A

Detail beacon (by resizing not to scale)

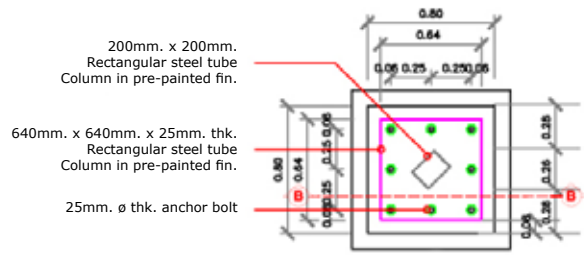

PLAN

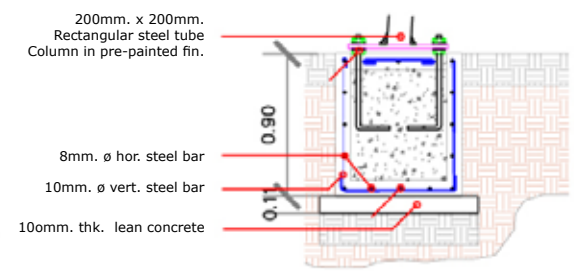

SECTION THRU B-B

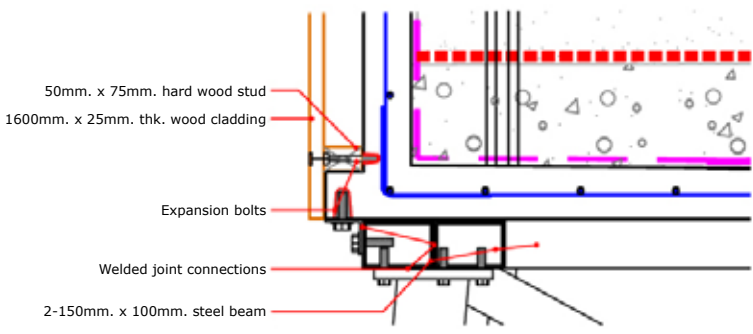

STEEL BEAM DETAILS

# Dammam Parks Design

Details of the documentation phases of the parks

In the documentation phase we made details for all the elements present in the parks including paving details and planting advices. Here you see two examples.

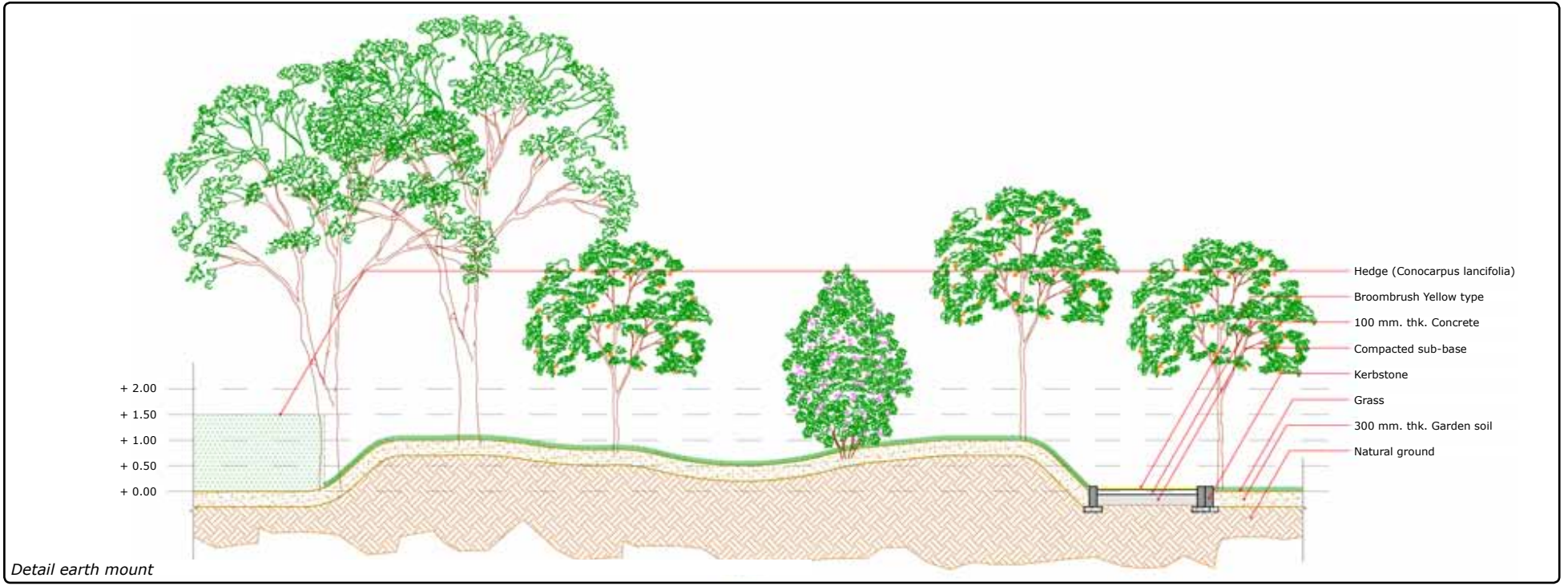



2010



2040

Fixing objectives & targets for the public (green) domain

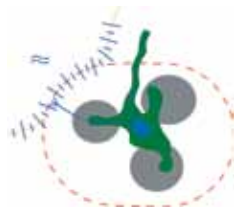

Defining the green and blue structure of the Metropolis

Step 1: Determination of the Development Program



A healthy and natural public domain  
Innovative planning & design solutions  
World class public functions & facilities

Step 2: Vision for the year 2040

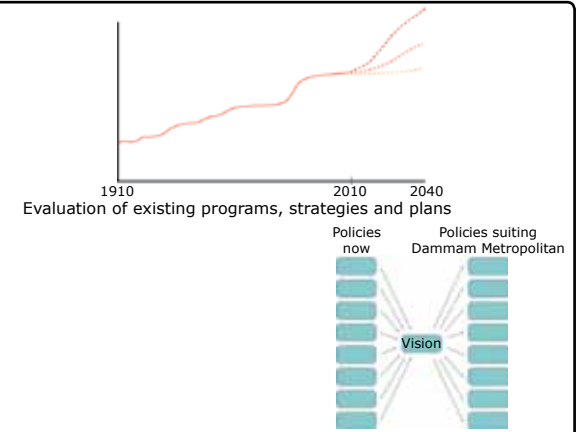

Evaluation of existing programs, strategies and plans

Adjustment of policies, rules and regulations

Step 3: Implementation Strategy



A general Master Plan will be made to structure the future development in maps

Step 4: Long term Development Master Plan

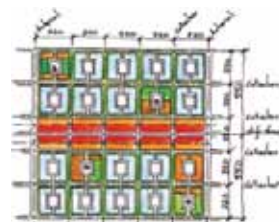

District guidelines



Neighbourhood guidelines

Guidelines on regional, city, and local scale will be set up

Step 5: Urban & Rural Development Guidelines

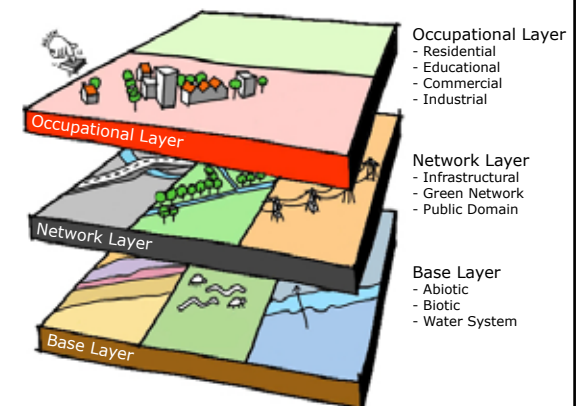

All future developments will be placed in the right layers and connected to each other to secure a solid process

Step 6: Implementation through the Belvedere Method

# Dammam Metropolitan Landscape Master Plan

**Location:** The Dammam Metropolitan Region consisting of the municipalities Dammam, Khobar and Dahran, Kingdom of Saudi Arabia  
**Scale levels:** Conceptual images  
**Language:** English

This was the project for which I was taken into service by Hollandia Lil Bi'a since it was a large Master Planning assignment and I have my Wageningen Master Planning roots. After our proposal for a landscape network in the Metropolis at which all other functions could be linked, we had a lot of presentations at the involved municipalities. In advance they were very enthusiastic and started to see the necessity of a plan on this scale for the region to insure better guidance of future developments. We stressed on the network and the systems in a Metropolitan Region and developed a proposal which focused on the process manage-

ment as well as on the execution of the Master Plan in clear steps. Especially our layer approach and the consequences, which developments on each layer have to another layer and therefore the whole Metropolis were understood. All the disputes between the participating stakeholders and the unfamiliarity with these kind of plans resulted in a cancel of the further execution of the plan.

Step 6: Implementation through the Belvedere Method

Step 1: Determination of the Development Program

Step 2: Vision for the year 2040

Step 3: Implementation Strategy

Step 4: Long term Development Master Plan

Step 5: Urban & Rural Development Guidelines

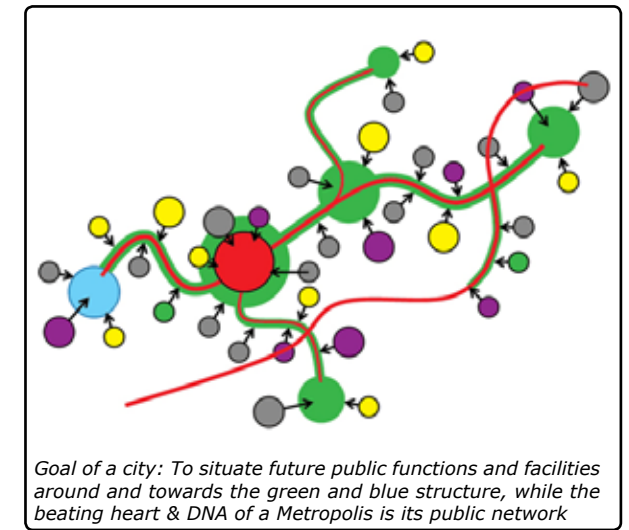
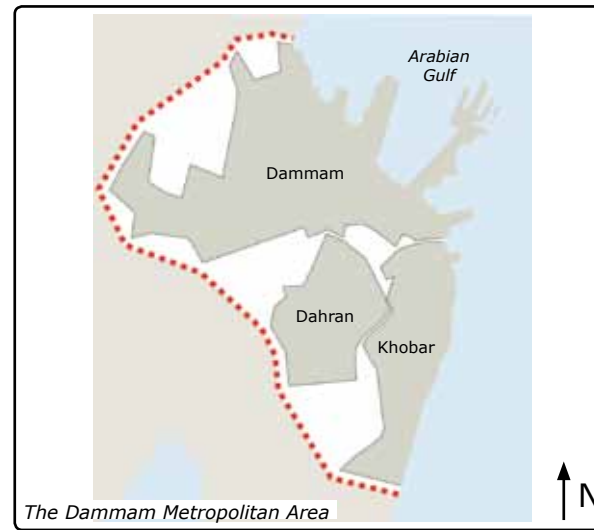

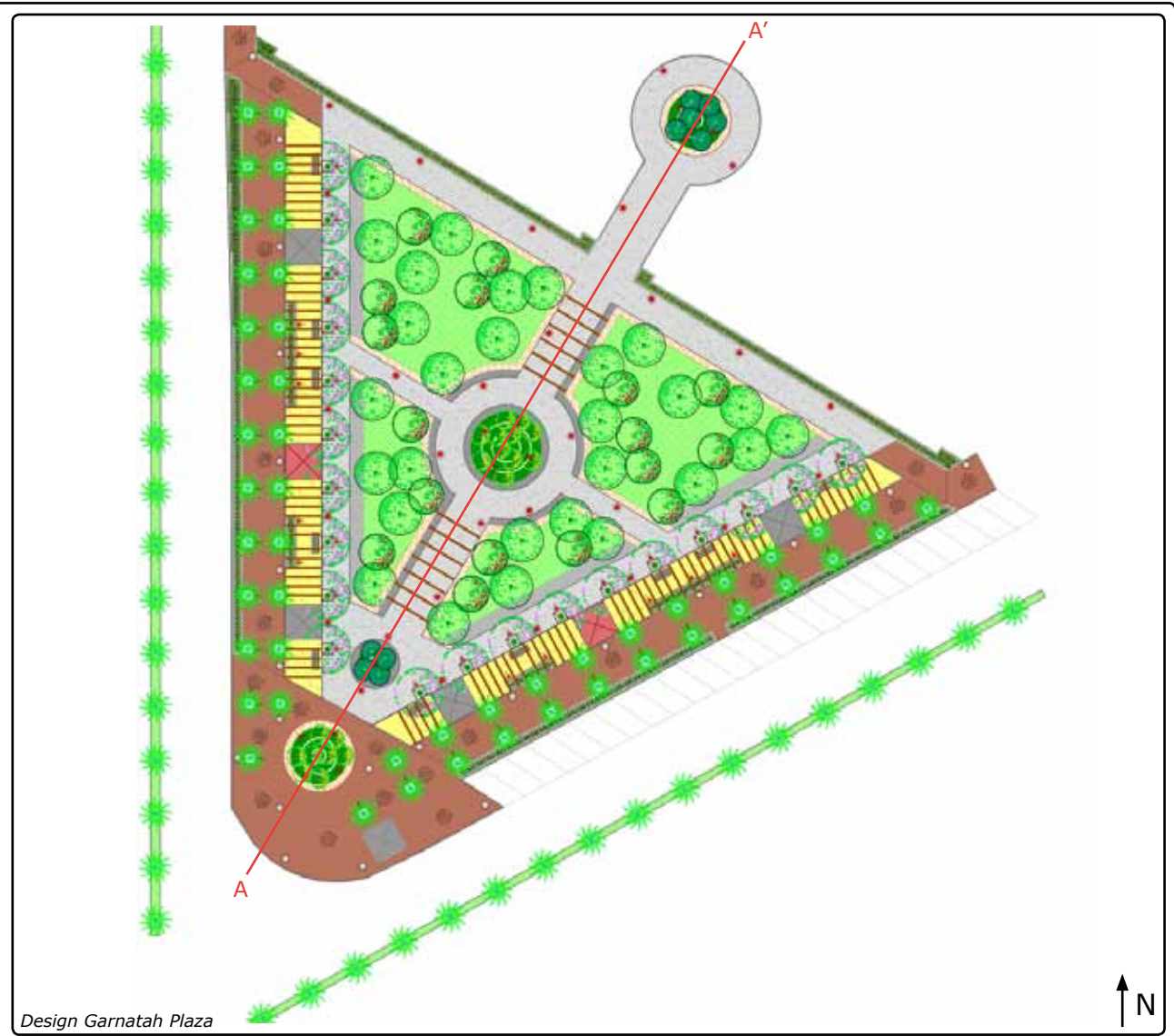
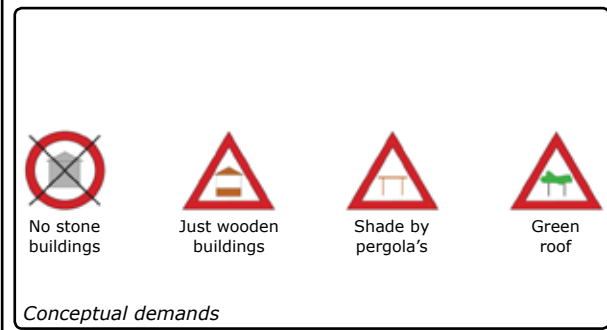
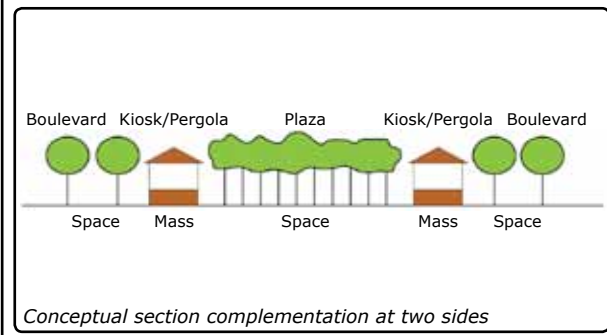
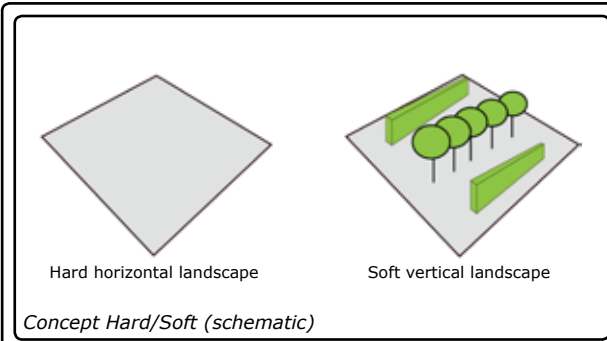

# Garnatah Plaza, Dammam

**Location:** Centre of Dammam, Kingdom of Saudi Arabia  
**Scale levels:** Varying from 1:600 till 1:15  
**Language:** English  
**Size:** 8554 m<sup>2</sup>

This design we also made for the Dammam Municipality. A main goal in the design for Garnatah Plaza was to complete the town planning situation on this site with the triangular plaza and busy roads all around. Therefore we introduced new edges at the borders of the plaza to complete the street profiles as well as to guarantee less noise and pollution within the plaza. This is done by two rows of wooden facilities connected by pergola's. These wooden rows were captured in vertical green elements to provide a more natural look and shade. Furthermore the whole plaza is bordered by hedges. To attract people in the plaza

and towards the connected park we designed a sequence of 'green islands' planted with the Dammam trees guiding to the people. The path structure is determined by one meter higher green terraces. This project will be executed in 2010.

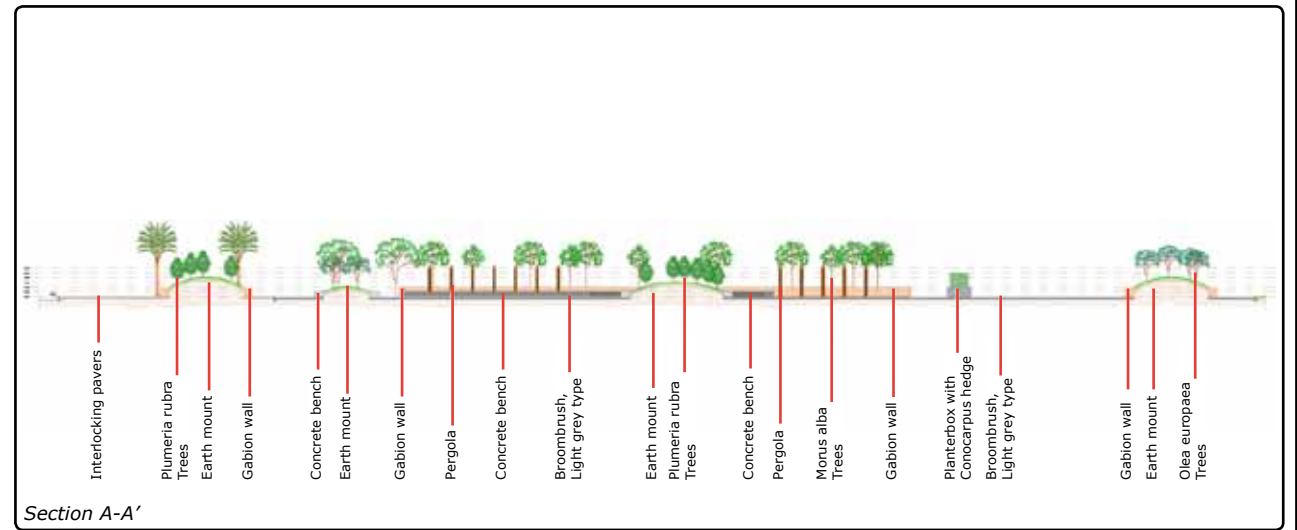
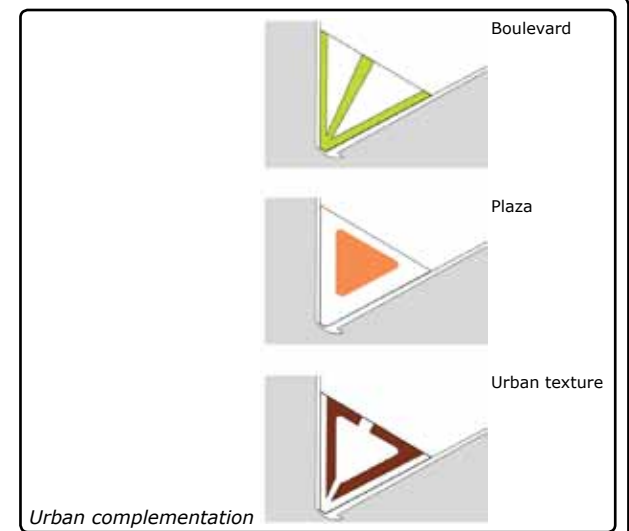



# Al Othman Twin Towers, Khobar

**Location:** Khobar, Kingdom of Saudi Arabia  
**Scale levels:** Varying from 1:1.000 till 1:10  
**Language:** English

This project we did for the Al Othman Group, a large company in the Kingdom of Saudi Arabia, busy in multiple fields from dairy products till building projects. The assignment was to make designs for the ground floor of a new hotel complex for the Marriott Group as well as for the roof gardens on top of two of the towers. The ground floor will be made of granite tiles and different colours of broombrush. The roof gardens on the wedding hall (with a major waterfall to the ground floor) and the park house will be open with water features and umbrella-like roof structures. For all elements we made execution details.

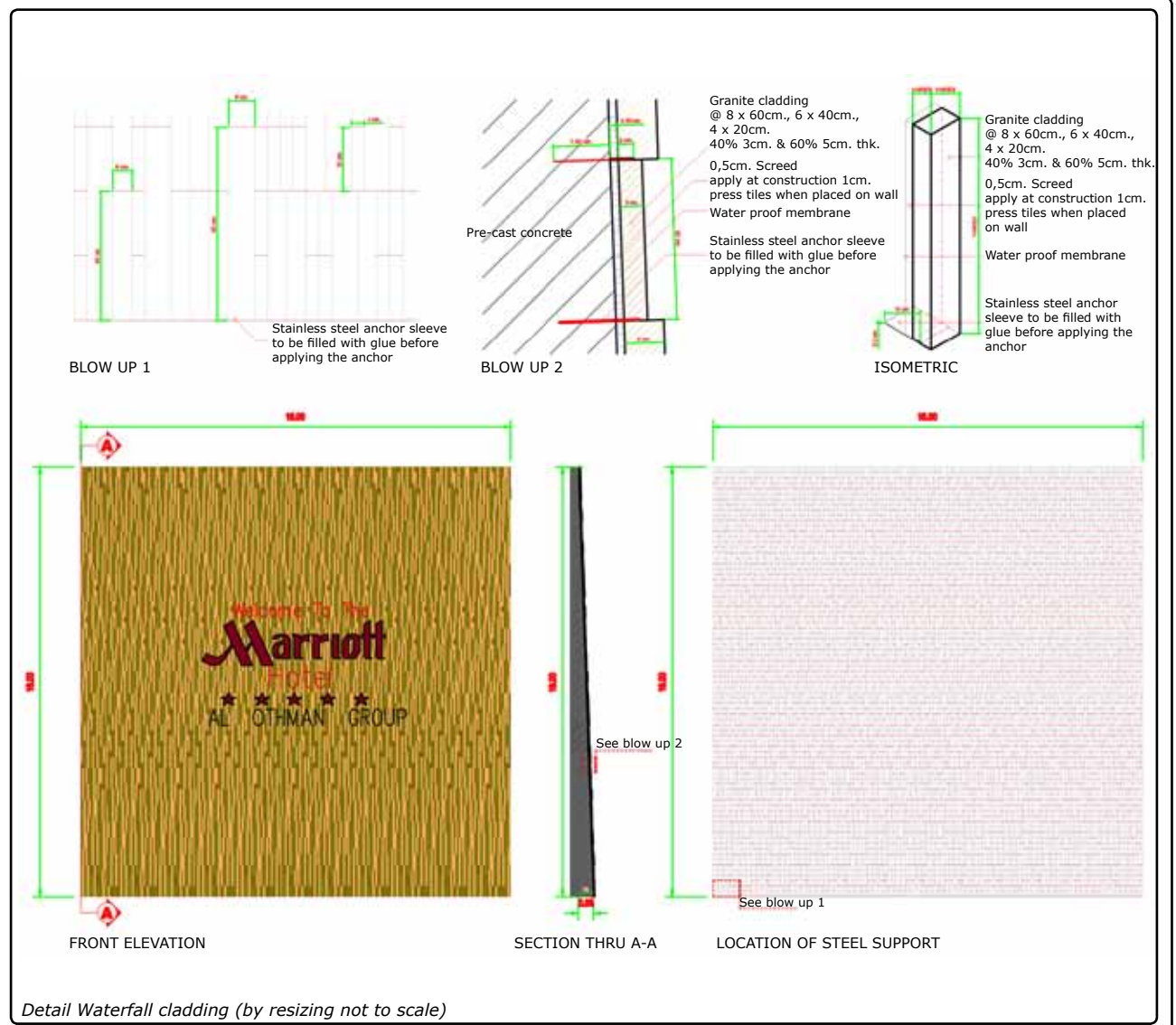

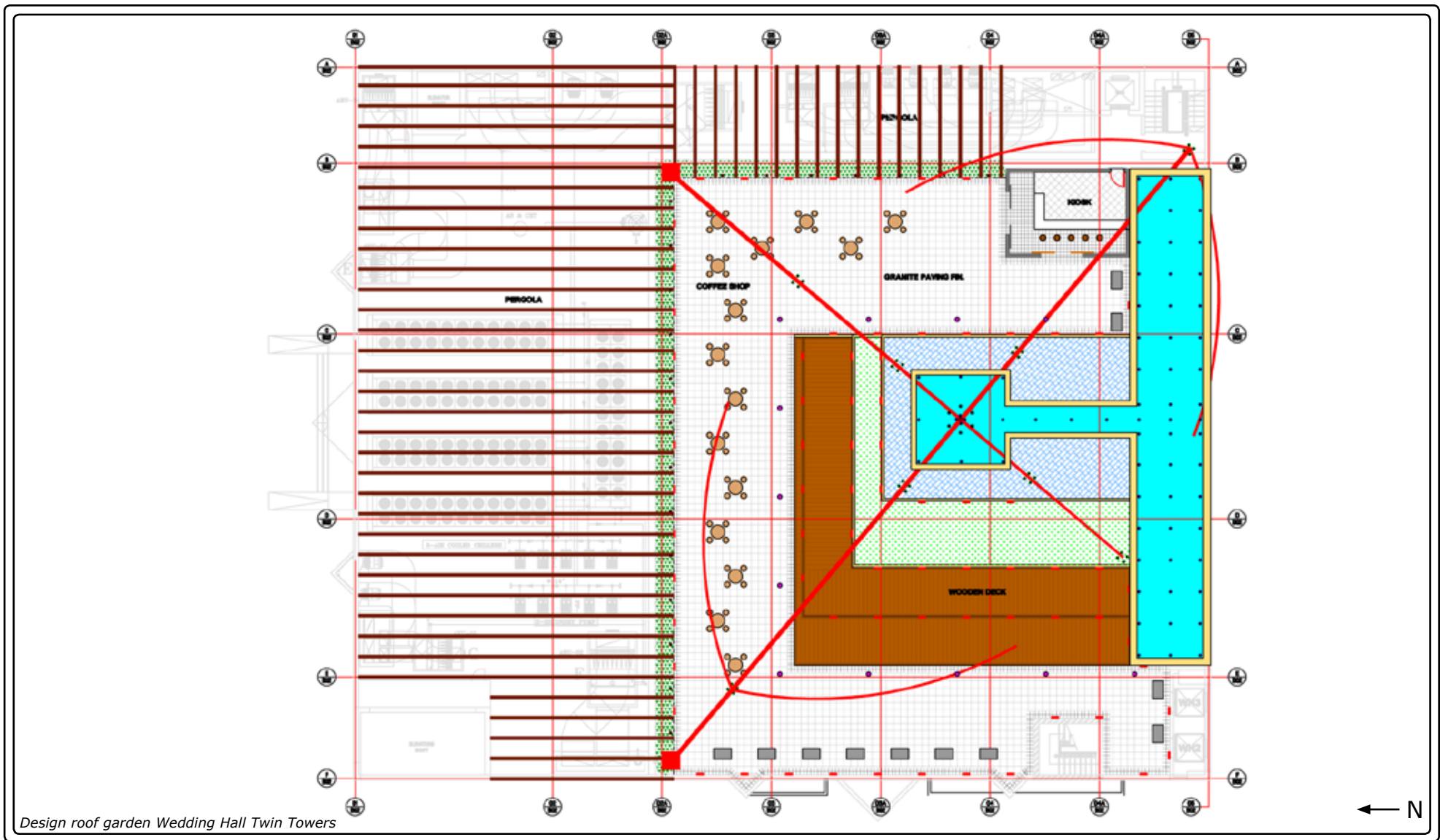

# Al Othman Twin Towers, Khobar

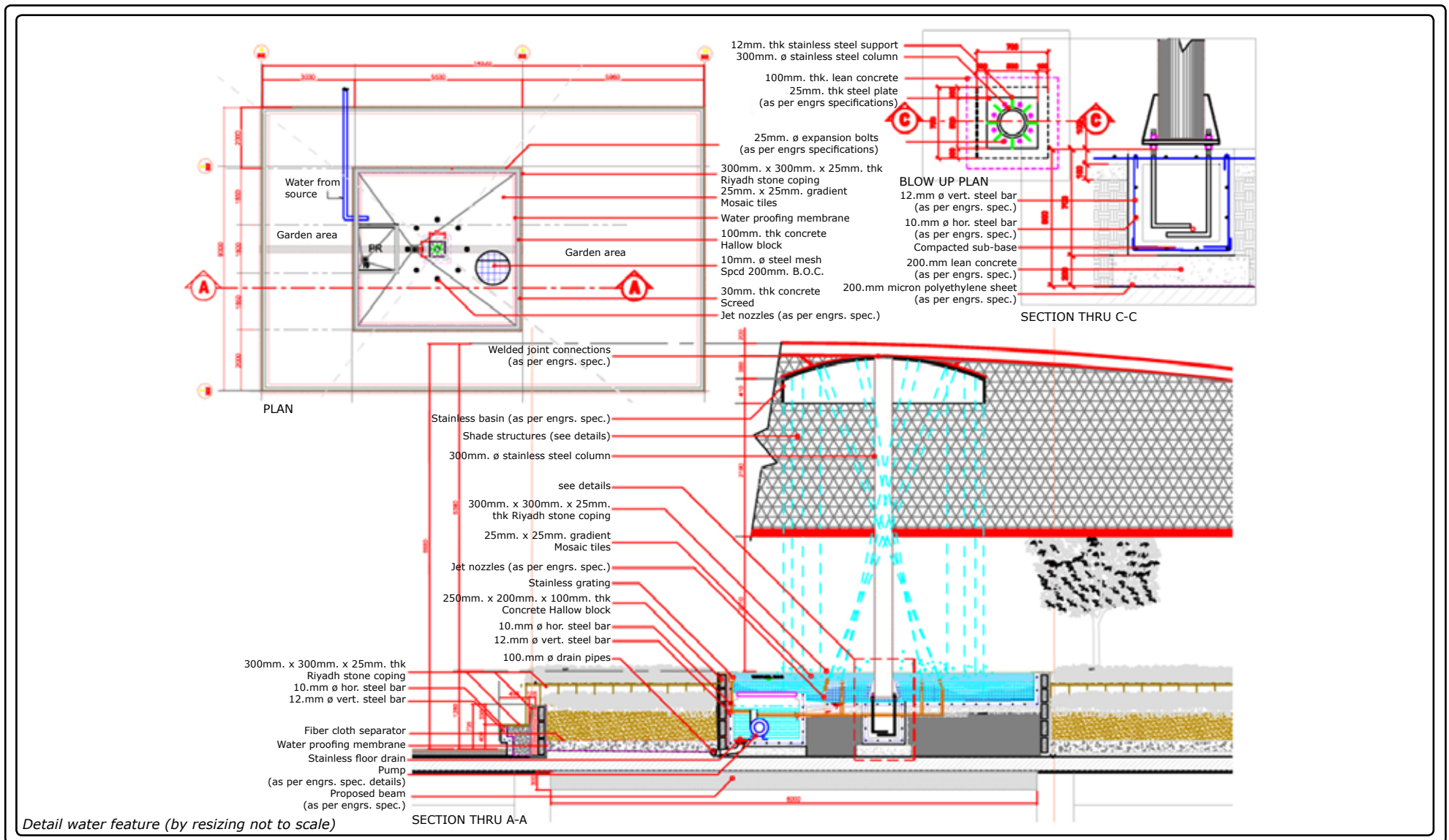



*Design Al Othman Compound*

# Al Othman Compound, Khobar

**Location:** Khobar, Kingdom of Saudi Arabia  
**Scale levels:** Varying from 1:1.000 till 1:10  
**Language:** English

Close to the Twin Towers project the Al Othman Group also planned to build a compound, which is a protected living environment most often for foreigners who work in the Kingdom. The main concept of the design is a flat ongoing ground floor composed of different types of granite and marble. This ground floor is the public domain in the compound stretching to every villa. At the backsides of the villa's walking paths are designed in green pedestrian zones. We also worked on the central playing ground.

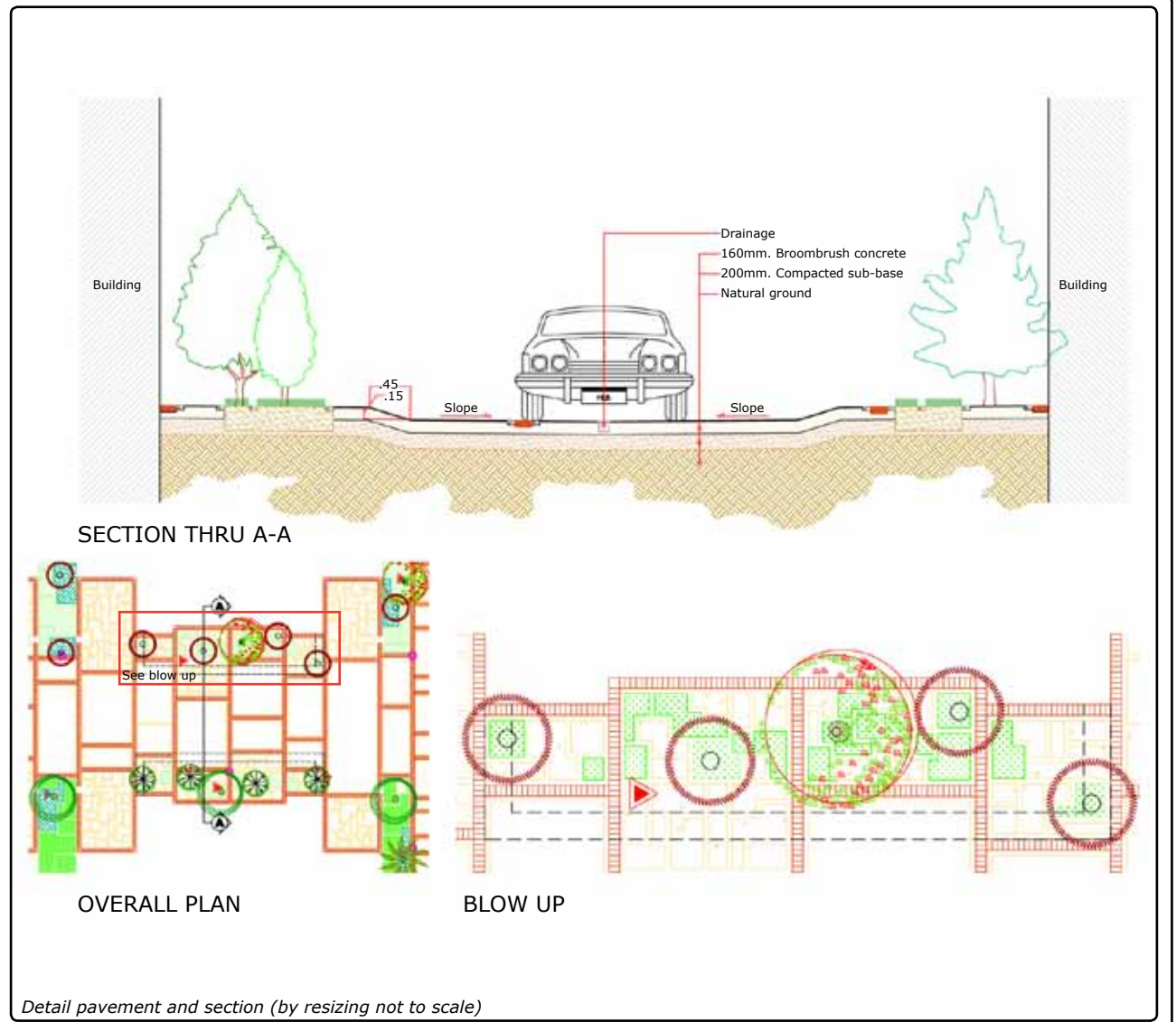

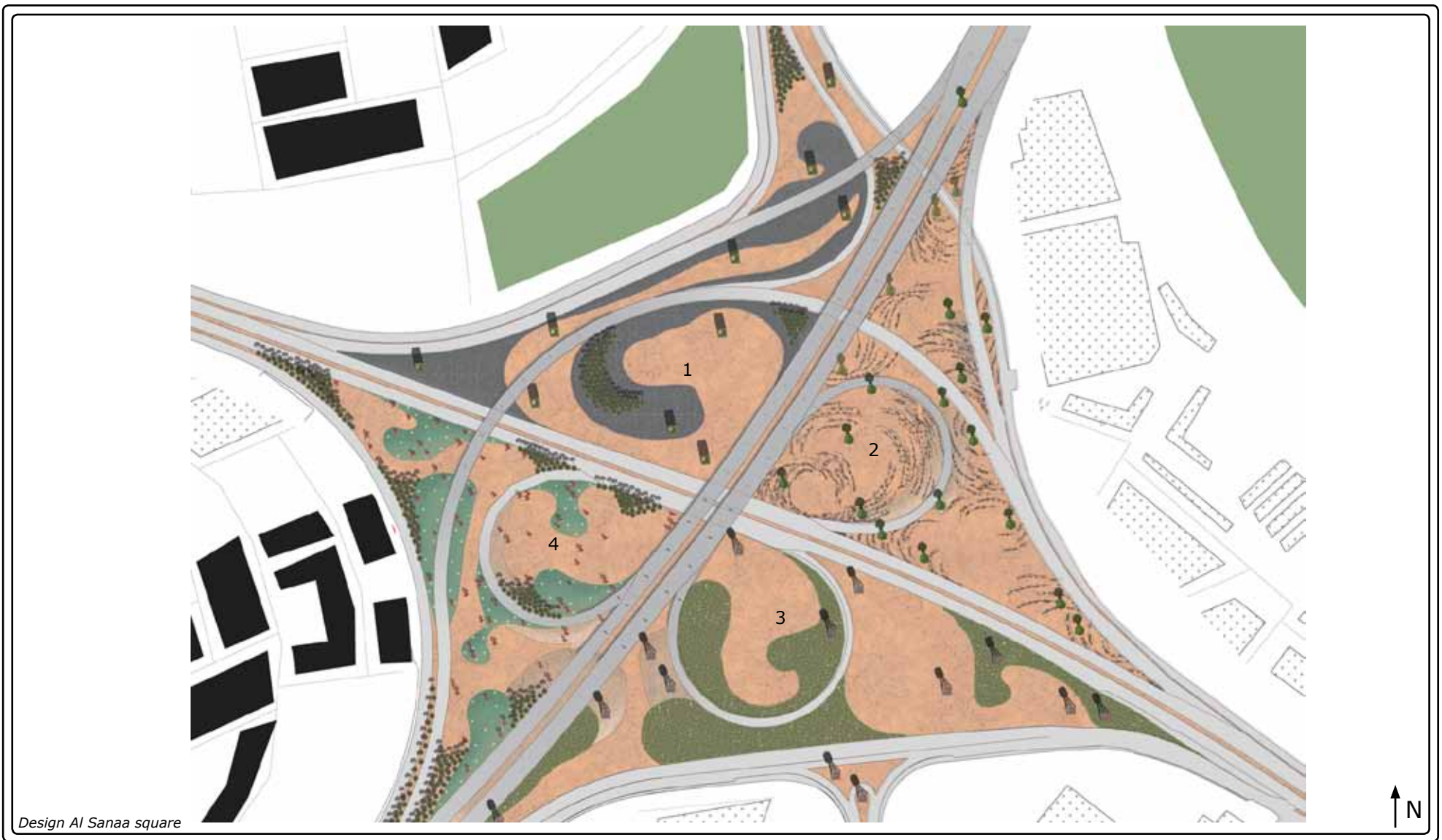

# Al Sanaa Square, Riyadh

**Location:** Riyadh, Kingdom of Saudi Arabia  
**Scale levels:** Varying from 1:1.000 till 1:20  
**Language:** English

This project, which we did for the Riyadh Municipality, is located at one of the major city gates of the ring road of Riyadh next to the cement factory. This is one of the landmarks in the city, since most buildings are not higher than two or three storeys, which is a rule in the *Shariah* law in the Kingdom. The main concept of the design is recycling. For most of the items we use in the design we use old materials which can be found in the Kingdom. For the cactuses we use old oil drums which will be welded together and the 'glass' hills will be made from old water bottles. The old wind mills will be gathered through out the Kingdom and for the steel structures we try to apprehend used metal as much as possible. Recycling is still

a quite new phenomena in the Kingdom and furthermore it reduces the costs of a design on such a large surface of in total 240.000 m<sup>2</sup>. The green towers will be six meter high and on top advertisement can be placed to regain income.

We detailed this design and all components in cooperation with constructors for feasibility. Now this project is the first project Hollandia Lil Bi'a will also lead in execution.

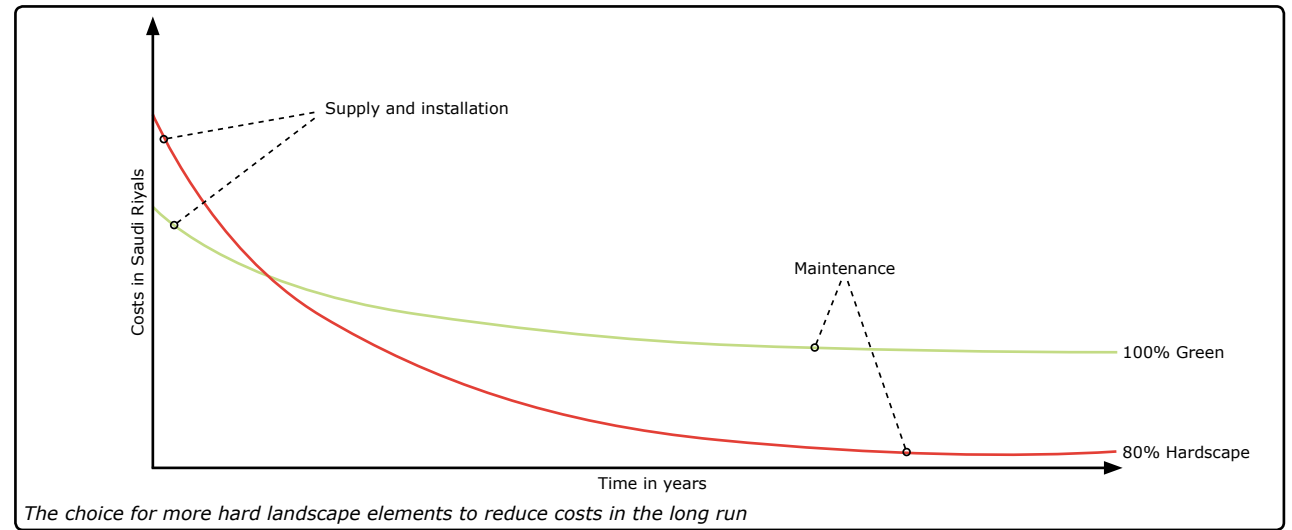
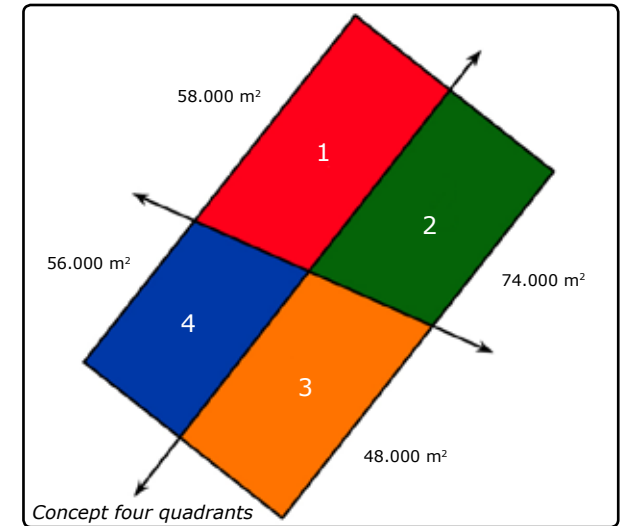



*Quadrant 1: Steel grass & Green Towers*



*Quadrant 2: Rocky Waves & Floating Trees*



*Quadrant 3: Pennisetum Fields & Windy Statues*

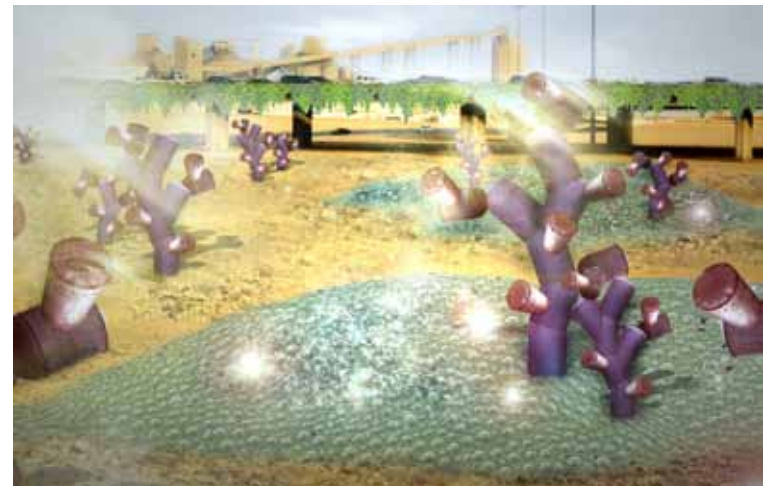

*Quadrant 4: Glass Mounds & Steel Cactuses*

# Al Sanaa Square, Riyadh

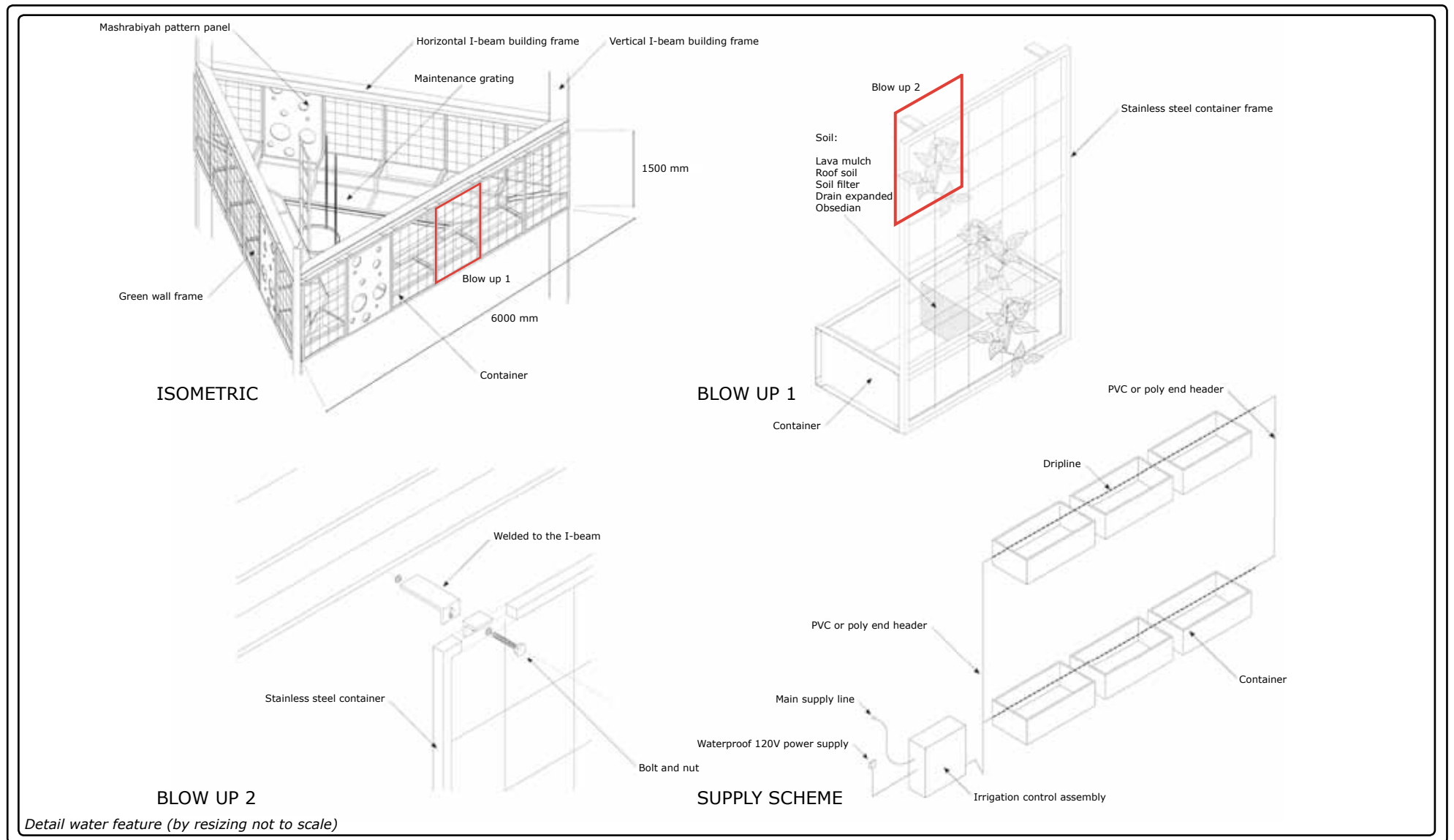



# Al Najm Park, Hofuf

**Location:** Hofuf, Kingdom of Saudi Arabia  
**Scale levels:** 1:500  
**Language:** English

While the Kingdom of Saudi Arabia is developing in high speed since the 1930's, most buildings are built from this date and less and less historical buildings are preserved. In Al Najm Park we were asked by the Hofuf Municipality to make a redesign for a former park in which an old bathhouse, a *Hammam*, was present. This is the focal point in our design and will be redeveloped into a spa. The present swimming pool will be renovated and integrated into this theme. Next to that we introduced small scale agriculture and herbal and medicinal gardens, connected to old farm houses. The old farm houses have a link to Holland and its traditions just as a wind and water mill. The whole site is strengthened in a new green framework

in which the old irrigational waterways (Al Najm) and therefore the role of water play an important role. The theme will be a new ecological health experience.



Present Hammam



Renovated Hammam

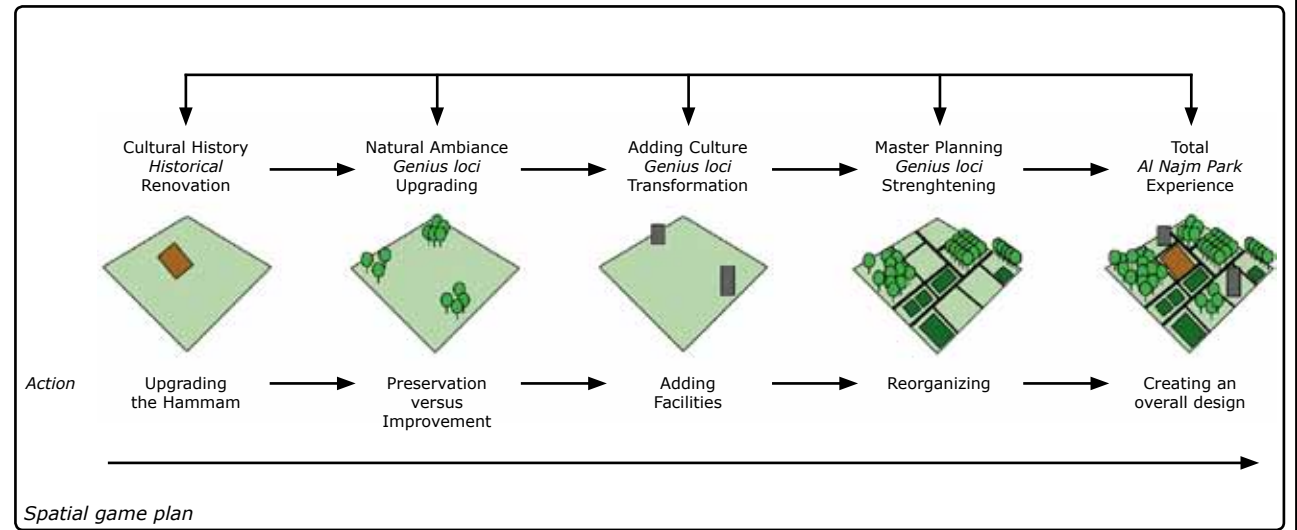



Design Al Uqair Recreational Development Master Plan



1. One way ring road with parallel parking



2. Beach front boulevard with BBQ areas



3. Pedestrian drop off with car block



# Al Uqair Waterfront, Al Ahsa

**Location:** Al Uqair, Al Ahsa Region, Kingdom of Saudi Arabia  
**Scale levels:** Varying from 1:2.000 till 1:50  
**Language:** English

This assignment was given by the Al Ahsa Regional Office in Hofuf. They developed two beach zones at the Arabian Gulf of each seven km long. The design they made for it was quite successful since it attracted visitors, but also very monotonous and suffered for some events, they had not taken into account in the design. Since the car has a dominant role in the Kingdom, people just drove through the unused park zones to get as close as possible to the beach where the pavilions were located. Therefore the beach itself had also turned into a concrete-like hard surface. Our task was to find a solution for this and we proposed to facilitate infrastructure which was closer to the

beach and would be guided in roads of which one could not get off. The access to the beach will be less desired since the pavilions are next to the parking bays at the roads. Furthermore the beach edge was planted with palms at such distances from each other, that cars could not pass them, or concrete elements are used. Then pedestrians are safer, the park zones will be more used and the beach can be transformed again into a soft sand surface.

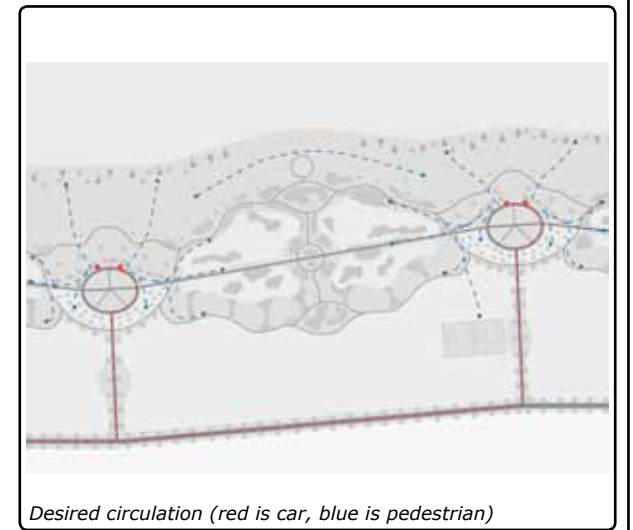
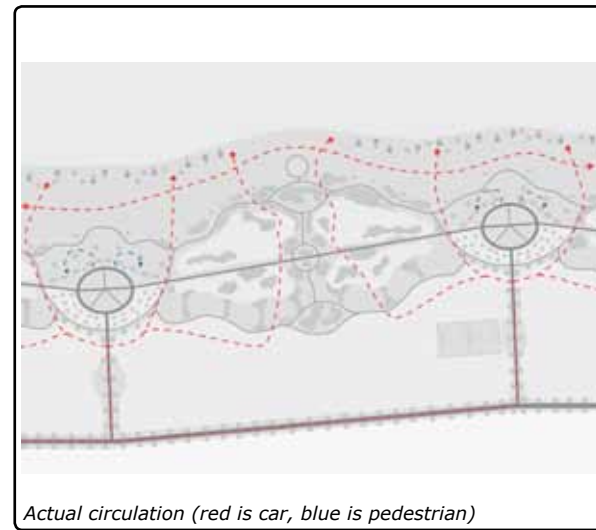
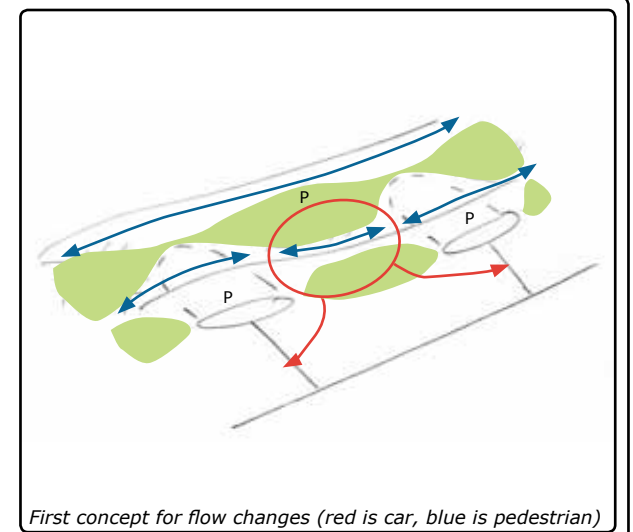



# Epilogue

This portfolio provides an insight in the status I find myself now as a landscape architect. I design by hand drawings as well as by computer, on rural and urban projects, in multiple countries and cultures and from Master Planning till detail scale levels. I like to work in the direct living environment of people and try to approach this from multiple working fields and aspects. I prefer to base my designs on the given contexts, their cultural history and their Genius loci, so their spirits. This does not mean I want preserve everything since preservation always includes development. This also counts for the meaning that environment has for humans who live, work, recreate or move around in it, which will keep on developing. Recommendation letters are available at request.

Niels Frencken

Nuenen, October 2010

## Colophon

© **Niels Frencken, Nuenen, October 2010**

All rights on the items in this document are preserved to the author. Nothing from this document can be reproduced or duplicated in what ever format without permission of the author

Author: Niels Frencken  
MSc Landscape Architecture

## Contact Information

N.W.H. Frencken  
TEL NL: 0031-(0)6-13453258  
TEL KSA: 00966-(0)56-4525135  
Email: [nwh.frencken@gmail.com](mailto:nwh.frencken@gmail.com)  
Internet: [www.frenckendesign.nl](http://www.frenckendesign.nl)